

PRODUCT CATALOGUE

LIFTING
JACKING
WINCHING
HEIGHT SAFETY

LOAD RESTRAINTS
MATERIAL HANDLING
CONSTRUCTION EQUIPMENTS
RETRACTABLE TYPE FALL ARRESTS



الرفع لخدمات السلامة ش م م
Lifting Safety Services LLC

■ Lifting ■ Jacking ■ Materials Handling ■ Height Safety



LiftinGear

Premier Lifting & Handling Products



StrapOn

Load Restraints & Lashings



G-Force

Safety @ Height Products



Introduction

We, Lifting Safety Services LLC (LSS), offer an extensive range of high quality lifting Equipment and lifting accessories for all industries. Working with our UK Principal Safety Lifting, LSS have our own branded equipment. LSS also work very closely with our Manufacturers and suppliers which enables us to monitor quality and receive excellent back up service which LSS can extend to our clients.

In this fast paced environment it is essential that we react to the needs of our valued Clients. Therefore we hold vast stocks of all popular lifting items and offer a fast and reliable service. We can deliver your orders to your site or you can visit our showroom to collect. Chain slings, wire rope slings and webbing slings are also supplied to customer requirements. We are also trained to reeve chain blocks and lever hoists to the required height of lift.

All our LiftinGear brand lifting, hoisting and winching equipment complies with current EU legislation and relevant certificates are issued with all items as standard practice. All of these products we offer is sold extensively throughout the UK. Our sales team can provide any specific technical information you may require on these products.

Our LiftinGear range of material handling equipment includes material lifts, pallet trucks, flat bed trolleys to name but a few. These products are particularly popular amongst the MEP contracting companies and facilities management and prove useful in tasks such as services installations and maintenance and for warehousing.

G-Force fall protection range offers an extensive choice of products to keep your workforce safe and secure whilst working at heights. G-Force products are manufactured in the EU and strictly conform with all necessary EN Standards. The range includes safety harnesses and lanyards, fall arrest blocks 6 - 28 meters, rescue tripods and winches, vertical lifelines etc. Load restraints, branded as StrapOn, are also available from stock.

Look forward to the opportunity of meeting with you soon.



LIFTING

JACKING



CONTENTS

H.S.C.Chain blocks	5	WALMAG Permanent Lifting Magnets	21
Lever hoists	6	■ WALMAG Permanent Lifting Magnets	
Low Headroom Combination Hoists	7	Winches & Accessories	22
■ Push Trolley		■ Electric Mini Wire Winch	
■ Geared Trolley		■ 7M PUSH BUTTON SWITCH SET	
Beam Clamps & Trolleys	8	■ Electric Wire Winch	23
■ Beam Clamps		■ Electric Chain Hoist	24- 26
■ F Type Plain Trolley		Camlok	27
■ F Type Geared Beam Trolley		Closed Spelter Sockets	28
Chainslings Grade 80	10	Open Spelter Sockets	29
■ Grade 80 Alloy Components	11	Open Wedge Sockets	30
■ Clevis Self Locking Hook	11	Skates Sets	31
■ Eye Self Locking Hook	11	Hydraulic Equipment	32
■ Clevis Sling Hook with latch	11	■ Toe Jacks	
■ Eye Sling Hook with latch	12	Materials Handling	33
■ Grade 80 Masterlink	12	■ Pallet Trucks	
■ Masterlink Assembly	12	■ High Lift Pallet Trucks	
■ Alloy Steel Latch Hook Swivel Type	13	■ Material Lift	34
■ Alloy Steel Latch Hook Eye Type	13	■ Flat Bed Trolley	
Wire Rope Slings	14	■ Hydraulic Hand Stacker	
■ End Termination Options		■ Barrel Tilting Fork Lift	35
Synthetic Slings	15	■ Floor Crane SDJ	
■ Webbing Slings		Fork Truck Attachments	36
■ Round Slings		■ Hydraulic Hand Stacker	
Alloy Shackles	16	■ Fork Mounted Jib	
Turnbuckles	17	■ Fork Extensions	
Collared Eyebolts	18	■ Multi Fork Extensions	
■ Metric Thread		■ Drum Rotator	37
Plate Clamps & Pipe Hooks	19	■ Drum Rotator Crane & Forks	
■ Vertical Plate Clamps 500kg to 5 tonne		■ Drum Tongs	
■ Horizontal Plate Clamps		■ Access Platform	
■ Pipe Liftng Hooks		Lashing Equipment	38
Winches & Accessories	20	■ Ratchet Lashing	
■ Snatch Blocks		■ Ratchet Load binder	
■ Industrial Hand Winch		■ Load binder Chain	
■ Wire Rope Winches			

WINCHING



MATERIAL HANDLING



LOAD RESTRAINTS



HEIGHT SAFETY



Height Safety Equipment	39	Modulift	48
■ Man Basket		High Performance Steel Wire Ropes	49-51
■ P-10 Safety Harness	40	Monitoring Equipment	52
■ P-30 Safety Harness		Steelwork Clamping System	53
■ Model P-10 Safety Harness		CA Lifton Hydraulic power systems	54
■ Model P-30 Safety Harness		ATG GLOVES	55
■ Model P-50 Safety Harness		Jtag Identification Tag	56-57
■ Shock Absorbing Lanyards	41	Crane Safety and Force Measurement	58
■ Work Positioning Lanyards	42	Safety Radio Remote Controls	59
■ Work Positioning Device		■ Nova-XL Series Radio Remote Controls	
■ Universal Safety Lanyards	43	■ GL-2 Series Remote Controls	
■ Karabiners & Attachments		■ Nova-L Series Radio Remote Controls	
■ Tripod & Winch	44	■ GL-3 Series Radio Remote Controls	60
■ P10 R Rescue Harness		■ GR Series Radio Remote Controls	61
■ Vertical Safety Lines		■ Ergo-F Handheld Radio Remote Controls	61
■ TM 12 Spider Multi-Purpose Lifting Device	45	■ Receivers – Enclosures	62-63
■ Stretcher	46	GIS – CH Electric Chain Hoist	
■ Rolex Mini Block		Energy and data transfer systems	64-66
■ Bosuns Chairs		MOBILIS Elite	
Retractable Type Fall Arresters			
■ Retractable Type Fall Arrestor CR200	47		
■ Retractable Type Fall Arrestor CR300			
■ Retrieval Fall Arrest Block CRW300			

H.S.C.CHAIN BLOCKS



Chain Block HS-S

- New improved lightweight design
- Guided hand chain cover reduces hand chain Snagging during use.
- Double pawl brake system.
- High quality bearings for long life and easy operation.
- High quality G80 load chain
- Heavy duty safety catches
- load chain also available with zinc plating

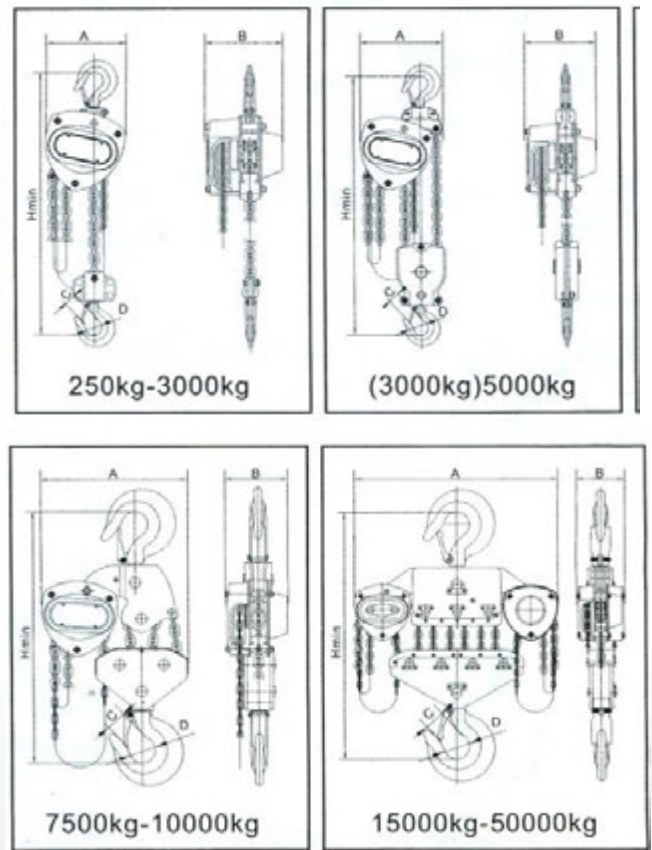

Capacity (kg)	250	500	1000	1500	2000	3000	3000	5000	7500	10000	15000	20000	30000	50000	
Standard Lift (m)	3	3	3	3	3	3	3	3	3	3	3	3	3	3	
No. Of Load Chain Falls	1	1	1	1	1	1	2	2	3	4	6	8	12	20	
Load Chain Diam Øxmm	4x12	5x15	6x18	7x21	8x24	10x30	7x21	10x30	10x30	10x30	10x30	10x30	10x30	10x30	
DIMENSIONS	A(mm)	120	146	161	182	202	255	230	250	430	460	718	840	870	746
	B(mm)	114	138	154	176	177	205	176	189	189	189	189	189	455	660
	C(mm)	21	23	27	33	35	39	39	45	47	59	70	80	85	110
	D(mm)	31	35	40	45	50	55	55	65	67	85	95	106	110	128
	Hmin (mm)	280	350	383	442	485	554	565	688	760	780	950	970	1400	2480

LEVER HOISTS

Leverhoists LHLG

- Lightweight & compact.
- Ease of use due to optimal gear ratio.
- Easy pull through of load chain (not when loaded).
- Rubberised handle for comfort.
- All Leverhoists fitted with 1.5 metres of load chain (longer available).
- Quality high strength load chain, 360° swivel latch hooks.
- Lifting chain length can be altered to your requirements.
- Heavy duty safety catch.



750kg
1500kg
3000kg



6 & 9 tonne

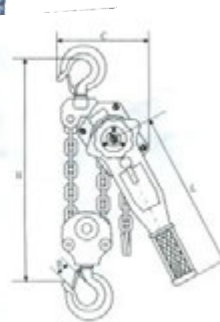
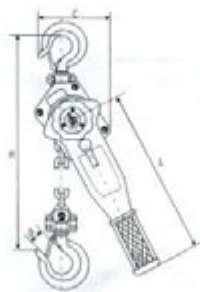
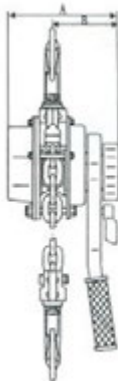

0.75T, 1.5T, 3T

6T, 9T

Product Code	Capacity	Standard H.O.L	No. Of Load Chain Falls	Load Chain Diam.	Head room Hook to Hook	Length Of Lever Handle	DIMENSIONS			
							(kg)	(M)	Ø x (mm)	(mm)
LH750X1.5M	750	1.5	1	6x18	320	280	148	90	136	30
LH1500X1.5M	1500	1.5	1	8x24	380	410	172	98	160	35
LH3000X1.5M	3000	1.5	1	10x30	480	410	200	115	180	40
LH6000X1.5M	6000	1.5	2	10x30	600	410	200	115	235	50
LH9000X1.5M	9000	1.5	3	10x30	700	410	203	115	316	85

LOW HEADROOM COMBINATION HOISTS

Push Trolley

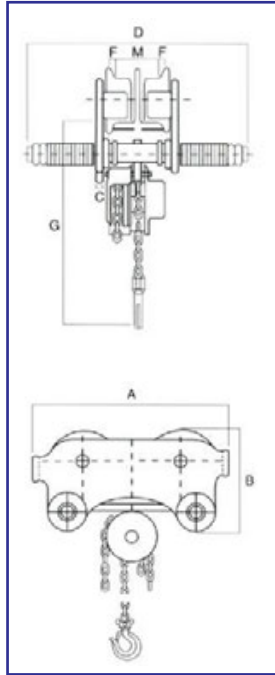

	500kg	1 tonne	2 tonne	3 tonne	5 tonne
I beam recommended	50-180	58-180	58-180	74-180	98-180
Std height of lift (m)	3	3	3	3	3
Falls of chain	1	1	2	2	2
Min radius of curve M	0.9	1	1.2	1.4	1.6
A	238	277	302	363	436
B	137	170	194	230	260
C	8	10	12	14	18
D	278	283	295	304	330
E	M18	M22	M27	M30	M42
F	3	3	3	3	3
G (CLOSE D HEAD-ROOM)	255	290	375	465	560

Geared Trolley

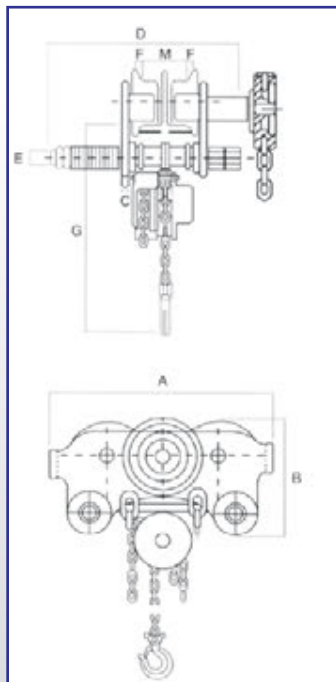

	500kg	1 tonne	2 tonne	3 tonne	5 tonne
I beam recommended	50-180	58-180	58-180	74-180	98-180
Std height of lift (m)	3	3	3	3	3
Falls of chain	1	1	2	2	2
Min radius of curve M	0.9	1	1.2	1.4	1.6
A	238	277	302	363	436
B	137	170	194	230	260
C	8	10	12	14	18
D	278	283	295	304	330
E	M18	M22	M27	M30	M42
F	3	3	3	3	3
G (CLOSE D HEAD-ROOM)	255	290	375	465	560

BEAM CLAMPS & TROLLEYS

Beam Clamps



- Adjustable beam clamp
- Pivoting eye to attach a hoist
- Easily adjustable to fit most beams by turning central threaded adjusting bar

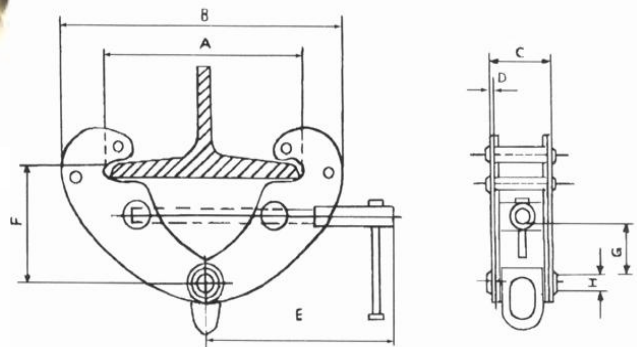

(Q TYPE)

Product Code	Capacity Tonnes	Adjustable Beam width (mm)	A Max	B		C	D	E	F		G Min	H	Weight (kgs)
				Min	Max				Min	Max			
BC1T	1	70-245	270	183	375	66	4	210	165	102	25	20	4.4
BC2T	2	70-245	270	183	375	74	6	210	165	102	25	20	5.1
BC3T	3	70-355	365	240	520	103	8	258	225	135	45	22	10.5
BC5T	5	70-355	365	240	520	111	10	258	225	135	45	28	17
BC10T	10	80-350	365	250	520	120	12	280	230	160	50	38	19

F Type Plain Trolley

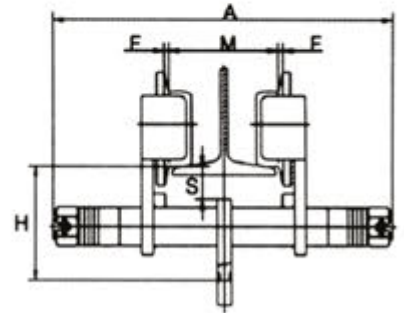
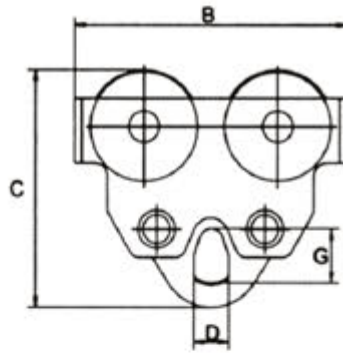

Item No.		01271	01272	01273	01274	01275	01276	01277	01278	01279	01280	01270	
Capacity Load	(T)	0.5	1	1.5	2	3	5	8	10	16	20	30	
Test Load	(kN)	7.35	14.71	22.06	29.42	44.13	61.29	98.06	122.58	196.12	245.17	367.74	
Min. Radius of Curve	(m)	0.8	0.9	1	1	1.2	1.3	2	2	3.5	3.5	6	
	A	a	236	303	310	317	333	355	372	378	449	449	-
		b	286	405	412	419	435	457	474	480	551	551	610
	B	194	236	250	268	322	362	426	442	555	555	710	
	C	176	196	210	226	266	301	388	396	498	498	608	
	H	75	96	102	109	124	142	185	190	236	233	285	
	S	30	38	38	38	40	42	45	45	65	58	65	
	D	28	32	36	42	52	62	72	72	95	95	105	
	G	32	40	45	52	63	74	110	110	135	135	155	
	F	1.5 - 3	1.5 - 3	1.5 - 3	1.5 - 3	1.5 - 3	1.5 - 3	2 - 3.5	2 - 3.5	2 - 3.5	2 - 3.5	2 - 3.5	
	a	50 - 152	64 - 203	74 - 203	88 - 203	100 - 203	114 - 203	124 - 203	124 - 203	136 - 203	136 - 203	-	
I-beam width range - mm	M	b	50 - 203	64 - 305	74 - 305	88 - 305	100 - 305	114 - 305	124 - 305	124 - 305	136 - 305	136 - 305	175 - 305

F Type Geared Beam Trolley

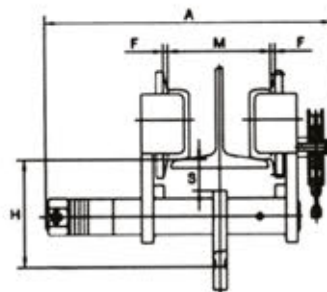
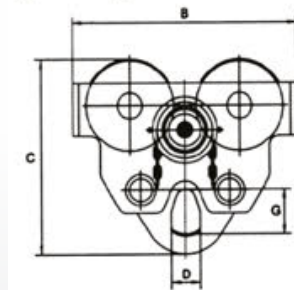

Item No:		01271A	01272A	01273A	01274A	01275A	01276A	01277A	01278A	1279A	01280A	01270A	01269A	
Capacity Load	(T)	0.5	1	1.5	2	3	5	8	10	16	20	30	40	
Test Load	(kN)	7.35	14.71	22.06	29.42	44.13	61.29	98.06	122.58	196.12	245.17	367.74	490.34	
Running Height	(m)	2.5	2.5	2.5	2.5	2.5	2.5	2.5	2.5	2.5	2.5	2.5	3	
Chain Pull to Lift Full Load	(N)	25	50	70	90	95	140	200	240	240	250	250	320	
Min. Radius of Curve	(m)	0.8	0.9	1	1	1.2	1.3	2	2	3.5	3.5	6	7	
	A	a	270	334	337	343	357	373	400	406	498	500	-	-
		b	322	436	439	445	459	475	502	508	602	604	674	758
	B	194	236	250	268	322	362	426	442	555	555	710	800	
	C	176	196	210	225	266	301	388	396	498	498	608	748	
	H	75	96	102	109	124	142	195	190	236	233	285	388	
	S	30	38	38	38	40	42	45	45	65	58	65	77	
	O	28	32	36	42	52	62	72	72	95	95	105	165	
	G	32	40	45	52	63	74	110	110	135	135	155	250	
	F	1.5 - 3	1.5 - 3	1.5 - 3	1.5 - 3	1.5 - 3	1.5 - 3	2 - 3.5	2 - 3.5	2 - 3.5	2 - 3.5	2 - 3.5	2 - 3.5	
	a	50 - 152	64 - 203	74 - 203	88 - 203	100 - 203	114 - 203	124 - 203	124 - 203	136 - 203	136 - 203	-	-	
I-beam width range - mm	M	b	50 - 203	64 - 305	74 - 305	88 - 305	100 - 305	114 - 305	124 - 305	124 - 305	136 - 305	136 - 305	175 - 305	190 - 320



CHAINSLINGS GRADE 80

Grade 80 chainslings can be assembled to your own requirements. We can supply chainslings ranging from 1.5 tonne to 67 tonne. Assembly can be single leg, 2 leg, 3 leg & 4 leg. (please see chart below to determine your requirements).



Eye type Foundry Hook



Clevis Latch hook



Latch Hook Eye type



Safety Hook Eye type



Safety Hook Clevis type



"C" Hook Clevis type



Component Connector



Eye type Grab Hook



Clevis type Grab Hook

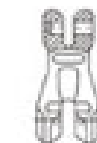

Shortening Clutch



Master Ring



Quad Master Ring

- Assembled to your exact requirements
- Swivel Hooks also available

								Sling Configuration
α Angle	90°	0 - 45°	45 - 60°	0 - 45°	45 - 60°	0 - 45°	45 - 60°	α Angle
Factor	1	1.4	1	2.1	1.5	2.1	1.5	Working Load Limit in Tonnes
7mm	1.5	2.12	1.50	3.15	2.24	3.15	2.24	
8mm	2.00	2.8	2.00	4.25	3.00	4.25	3.00	
10mm	3.15	4.25	3.15	6.70	4.75	6.70	4.75	
13mm	5.3	7.50	5.30	11.20	8.00	11.20	8.00	
16mm	8.00	11.20	8.00	17.00	11.80	17.00	11.80	
20mm	12.50	17.50	12.50	26.50	19.00	26.50	19.00	
22mm	15.00	21.20	15.00	31.50	22.40	31.50	22.40	
26mm	21.20	30.00	21.00	45.00	31.50	45.00	31.50	
32mm	31.50	45.00	31.50	67.00	47.50	67.00	47.50	

GRADE 80 ALLOY COMPONENTS

Clevis Self Locking Hook

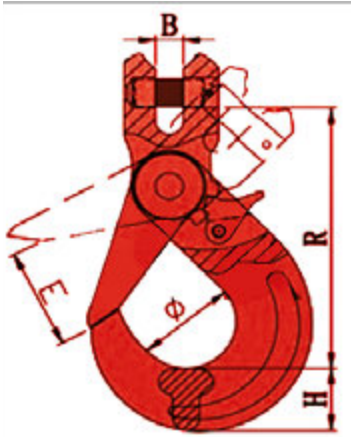

CODE	CLEVIS SELF LOCKING HOOK	SWL (Tonne)
LG-CSLH7-8	7 - 8MM CLEVIS SELF LOCKING HOOK	1.50
LG-CSLH10	10MM CLEVIS SELF LOCKING HOOK	3.15
LG-CSLH13	13MM CLEVIS SELF LOCKING HOOK	5.30
LG-CSLH16	16MM CLEVIS SELF LOCKING HOOK	8.00
LG-CSLH20	20MM CLEVIS SELF LOCKING HOOK	12.50
LG-CSLH22	22MM CLEVIS SELF LOCKING HOOK	15.50
LG-CSLH26	26MM CLEVIS SELF LOCKING HOOK	21.60
LG-CSLH32	32MM CLEVIS SELF LOCKING HOOK	32.00

Eye Self Locking Hook

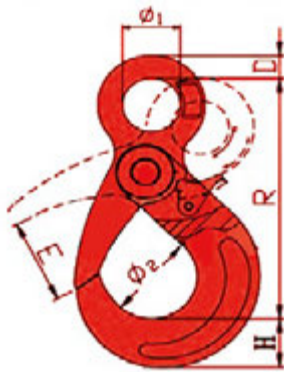

CODE	EYE SELF LOCKING HOOK	SWL (Tonne)
LG-ESLH7-8	7 - 8MM EYE SELF LOCKING HOOK	1.50
LG-ESLH10	10MM EYE SELF LOCKING HOOK	3.15
LG-ESLH13	13MM EYE SELF LOCKING HOOK	5.30
LG-ESLH16	16MM EYE SELF LOCKING HOOK	8.00
LG-ESLH20	20MM EYE SELF LOCKING HOOK	12.50
LG-ESLH22	22MM EYE SELF LOCKING HOOK	15.50
LG-ESLH26	26MM EYE SELF LOCKING HOOK	21.60

Clevis Sling Hook with latch



CODE	CLEVIS SLING HOOK WITH LATCH	SWL (Tonne)
LG-CSLH7-8	7 - 8MM CLEVIS SLING HOOK WITH LATCH	1.50
LG-CSLH10	10MM CLEVIS SLING HOOK WITH LATCH	3.15
LG-CSLH13	13MM CLEVIS SLING HOOK WITH LATCH	5.30
LG-CSLH16	16MM CLEVIS SLING HOOK WITH LATCH	8.00
LG-CSLH20	20MM CLEVIS SLING HOOK WITH LATCH	12.50
LG-CSLH22	22MM CLEVIS SLING HOOK WITH LATCH	15.50
LG-CSLH26	26MM CLEVIS SLING HOOK WITH LATCH	21.60
LG-CSLH32	32MM CLEVIS SLING HOOK WITH LATCH	32.00

GRADE 80 ALLOY COMPONENTS



Eye Sling Hook with latch

CODE	EYE SLING HOOK WITH LATCH	SWL (Tonne)
LG-ESLH10	10MM EYE SLING HOOK WITH LATCH	3.15
LG-ESLH13	13MM EYE SLING HOOK WITH LATCH	5.30
LG-ESLH16	16MM EYE SLING HOOK WITH LATCH	8.00
LG-ESLH20	20MM EYE SLING HOOK WITH LATCH	12.50
LG-ESLH22	22MM EYE SLING HOOK WITH LATCH	15.50
LG-ESLH26	26MM EYE SLING HOOK WITH LATCH	21.60

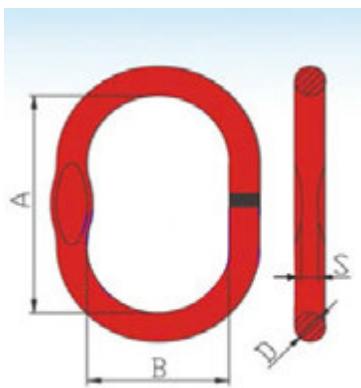

Grade 80 Masterlink

CODE	A (mm)	B (mm)	D (mm)	SWL (Tonne)
LG13B6	115	60	13	2.40
LG16B6	120	70	16	3.80
LG20B7	170	90	20	5.80
LG28B7	270	140	28	10.50
LG36B6	285	155	36	21.20
LG40B7	300	160	40	25.00
LG45B6	320	170	45	34.00
LG70B6	500	250	70	84.00
LG22ML	180	100	22	8.20
LG25MLS	180	100	25	11.50
LG32ML	275	145	32	16.00
LG36ML	270	140	36	23.00
LG45ML	470	250	45	24.50
LG50ML	350	190	50	45.00
LG60ML	410	220	60	60.00
LG90ML	500	300	90	150.00



Masterlink Assembly

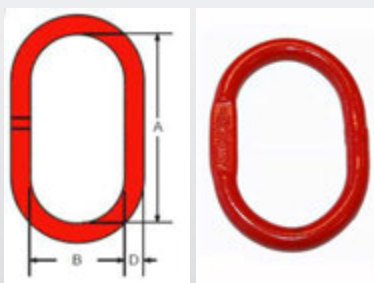

CODE	Main Link			Sublink			SWL (TONNE)
	A	B	D	a (mm)	b (mm)	d (mm)	
LG16QA	160	90	17	100	60	14	3.20
LG20QA	160	90	20	120	70	17	5.00
LG22QA	180	100	22	150	70	18	8.00
LG28QA	275	145	28	160	90	21	12.00
LG32QA	275	145	32	200	110	25	17.40
LG40QA	280	155	40	200	120	32	29.00
LG45QA	320	175	45	240	130	35	36.50
LG50QA	350	195	50	350	185	43	45.20
LG58QA	410	220	58	350	200	50	59.90
LG60QA	410	220	60	360	200	50	59.90

GRADE 80 ALLOY COMPONENTS

Alloy Steel Latch Hook Swivel Type

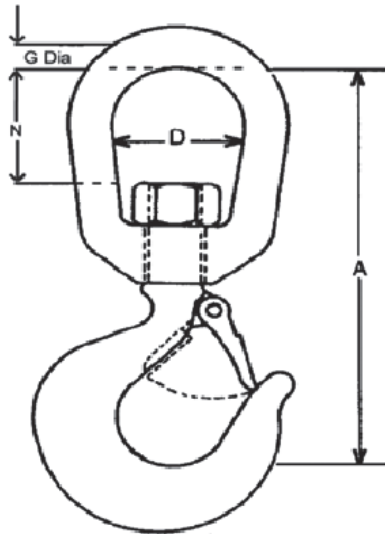

S.W.L.	A	D	G	N	WEIGHT EACH KGS
TONNES	mm	mm	mm	mm	
1	113	31	9	23	0.6
1.5	134	38	12	33	0.93
2	151	44	15	40	1.27
3	161	44	15	41	1.92
4.5	189	51	19	44	2.67
7	243	63	25	58	4.84
11	282	70	28	60	7.75

Alloy Steel Latch Hook Eye Type

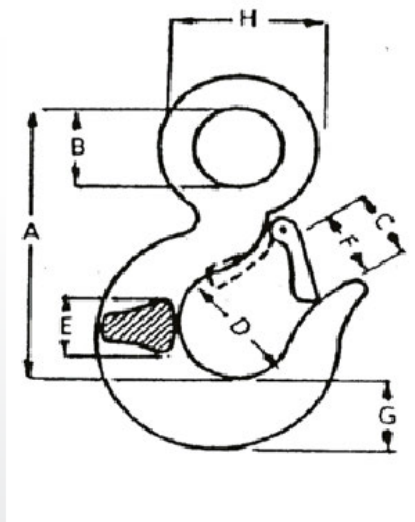

S.W.L.	A	B	C	D	E	F	G	H	WEIGHT EACH KGS
TONNES	mm	mm	mm	mm	mm	mm	mm	mm	
1	82	19	25	32	15	22	20	38	0.25
1.5	93	25	27	34	18	24	22	45	0.43
2	104	28	28	37	19	25	26	52	0.67
3	119	32	32	40	22	28	29	61	0.87
4.5	146	40	38	50	29	34	37	75	1.85
7	187	51	48	60	35	43	46	97	4.05
11	230	62	58	72	42	48	58	119	6.87
15	255	72	65	84	50	57	66	136	9.93

WIRE ROPE SLINGS



- Made to your exact requirements.
- Galvanised wire (other types available).
- Multi leg slings manufactured to your requirements.
- Winch ropes also made to order.
- Stainless steel rope supplied.
- Wire rope crimping tools.
- We can also swage using tapered ferrules.

End Termination Options



Reeveable Eye



Thimble Eye



Solid Eye



Hook Fitting

Rope Diameter mm	Working Load Limit					Min Break Load Tonne	Proof Load Per Leg @0 Tonne
	Single Leg Tonne	Leg Angle 0-90		Leg Angle 0-120			
		2 Leg Tonne	3 & 4 leg Tonne	2Leg Tonne	3 & 4 leg Tonne		
8	0.822	1.1	1.7	0.822	1.2	4.11	1.64
9	1.0	1.4	2.1	1.0	1.5	5.20	2.0
10	1.3	1.8	2.7	1.3	1.9	6.42	2.6
11	1.5	2.2	3.2	1.5	2.3	7.77	3.2
12	1.8	2.6	3.9	1.8	2.8	9.25	3.6
13	2.1	3.0	4.5	2.1	3.2	10.8	4.4
14	2.5	3.5	5.3	2.5	3.8	12.6	5.0
16	3.3	4.6	6.9	3.3	4.9	16.4	6.6
18	4.1	5.8	8.7	4.1	6.2	20.8	8.4
19	4.6	6.4	9.7	4.6	6.9	23.1	9.2
20	5.1	7.2	10.8	5.1	7.7	25.7	10.2
22	6.2	8.7	13.0	6.2	9.3	31.1	12.4
24	7.4	10.3	15.5	7.4	11.1	37.0	14.8
26	8.7	12.1	18.2	8.7	13.0	43.4	17.4
28	10.1	14.1	21.1	10.1	15.1	50.4	20.2
32	13.1	18.4	27.6	13.1	19.7	65.7	26.2
35	15.7	22.0	33.0	15.7	23.6	78.7	31.4
36	16.6	23.3	35.0	16.6	25.0	83.3	33.4
38	18.5	26.0	39.0	18.5	27.8	92.8	37.2
40	20.6	28.8	43.2	20.6	30.9	103.0	41.2
44	24.8	34.7	52.1	24.8	37.2	124.0	49.6
48	29.6	41.4	62.1	29.6	44.4	148.0	59.2
52	34.8	48.7	73.1	34.8	52.2	174.0	69.6
54	37.4	52.3	78.5	37.4	56.1	187.0	74.8
56	40.2	56.3	84.4	40.2	60.3	201.0	80.4
60	46.2	64.7	97.0	46.2	69.3	231.0	92.4
64	54.8	76.7	115.1	54.8	82.2	274.0	109.6
71	66.6	93.2	139.8	66.6	99.9	333.0	133.2
77	77.8	108.9	163.4	77.8	116.7	389.00	155.6

These tables are in compliance with BS EN 13414-1:2003 / A2 2008 Uniform load method calculation used throughout WLL of less than 1t are normally cited in kg.

SYNTHETIC SLINGS







Webbing Slings

- Manufactured from 100% high tenacity polyester material.
- They are available in three basic types; Simplex, Duplex & endless with either soft becket eyes or metal reeveable or non reeveable terminal fittings .
- Working load limits from 500kg to 24 tonne and to almost any length.
- Multi leg slings also available.

Round Slings

- Manufactured from high tenacity polyester yarn.
- Covered by a seamless tightly woven, heavy duty polyester tubular sleeve.
- Working load limits from 1 tonne to 30 tonne
- Available from 0.5 meter E.W.L to 15 meters E.W.L
- Wear sleeves readily available for webbing & roundlings.
- A soft alternative to wire or chain.
- Safety factor 7:1

	 Straight Pull	 Choke Lift	 Basket Lift 0 to 7°	 Basket Lift 0 to 45°	 Basket Lift 45 to 60°
Colour	Tonne	Tonne	Tonne	Tonne	Tonne
Violet	1	0.8	2	1.4	1
Green	2	1.6	4	2.8	2
Yellow	3	2.4	6	4.2	3
Grey	4	3.2	8	5.6	4
Red	5	4.0	10	7.0	5
Brown	6	4.8	12	8.4	6
Blue	8	6.4	16	11.2	8
Orange	10	8.0	20	14.0	10
Orange	12	9.6	24	16.8	12
Orange	15	12.0	30	21.0	15
Orange	20	16.0	40	28.0	20
Orange	30	24.0	60	42.0	30

Larger capacity slings available

- ◆ Flat belt slings up to 48 tonne capacity
- ◆ Roundslings available up to 100 tonne

ALLOY SHACKLES

(meets the performance requirements of RR-C-271 BSEN13889)



- Tested & Certified
- High Quality
- Fully Embossed for Easy Identification
- Safety Factor 6:1
- Galvanised Finish

Screw Pin Dee

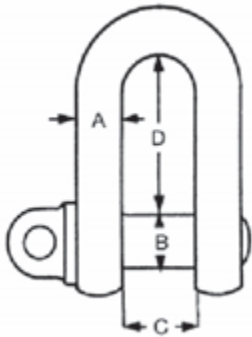

Screw Pin Bow

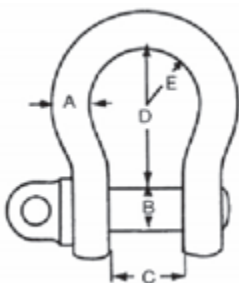

W.L.L. Tons	A mm	B mm	C mm	D		2E mm	WEIGHT EACH Kgs
				BOW	DEE		
				mm	mm		
0.33	5	6	9.5	22	-	16	0.02
0.5	7	8	12	29	25	20	0.05
0.75	9	10	13.5	32	27	21	0.11
1.00	10	11	17	36.5	31	26	0.15
1.5	11	12	18.5	43	37	29	0.21
2.00	13.5	16	22	51	43	32	0.37
3.25	16	19	27	64	51	43	0.65
4.75	19	22	31	76	59	51	1.06
6.5	22	25	36	83	73	58	1.56
8.5	25	28	43	95	85	68	2.32
9.5	28	32	47	108	90	75	3.28
12.00	32	35	51	115	94	83	4.51
13.5	35	38	57	133	115	92	5.93
17.00	38	42	60	146	127	99	7.89
25.00	45	50	74	178	149	126	13.4
35.00	50	57	83	197	171	138	18.85
55.00	65	70	105	254	208	180	37.86
85.00	90	96	146	381	-	-	60

Nut & Bolt Pin Dee

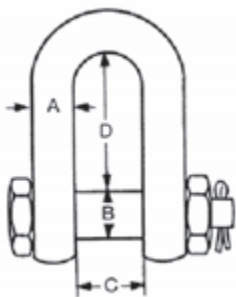

Nut & Bolt Pin Bow

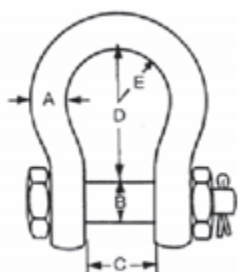

W.L.L. Tons	A mm	B mm	C mm	D		2E mm	WEIGHT EACH Kgs
				BOW	DEE		
				mm	mm		
0.5	7	8	12	29	-	20	0.07
0.75	9	10	13.5	32	-	21	0.13
1.00	10	11	17	36.5	-	26	0.17
1.5	11	12	18.5	43	-	29	0.25
2.00	13.5	16	22	51	43	32	0.44
3.25	16	19	27	64	51	43	0.79
4.75	19	22	31	76	59	51	1.26
6.5	22	25	36	83	73	58	1.88
8.5	25	28	43	95	85	68	2.78
9.5	28	32	47	108	90	75	3.87
12.00	32	35	51	115	94	83	5.26
13.5	35	38	57	133	115	92	6.94
17.00	38	42	60	146	127	99	8.79
25.00	45	50	74	178	149	126	14.99
35.00	50	57	83	197	171	138	20.65
55.00	65	70	105	254	203	180	41.05
85.00	75	80	127	330	230	190	62.24
120.00	90	95	146	381	267	238	110

TURNBUCKLES

Galvanised Drop Forged Open Body Generally to US FED SPEC-FF-T-791b Turnbuckles Tested



A in	BB in	BB mm	S mm	B mm	D mm	G mm	R mm	BOLT DIA mm	N mm	M mm	WEIGHT EA KGS
3/8	6	152	13	12	14	22	28	8	302	454	0.37
1/2	6	152	18	15	17	27	36	9	338	490	0.73
1/2	9	228	18	15	17	27	36	9	414	642	0.79
1/2	12	304	18	15	17	27	36	9	490	795	0.96
5/8	6	152	22	19	22	33	44	12	394	546	1.37
5/8	9	228	22	19	22	33	44	12	470	698	1.31
5/8	12	304	22	19	22	33	44	12	546	851	1.53
5/8	18	457	22	19	22	33	44	12	701	1150	1.86
3/4	6	152	25	23	25	38	54	15	432	584	1.86
3/4	9	228	25	23	25	38	54	15	508	736	2.31
3/4	12	304	25	23	25	38	54	15	584	889	2.56
3/4	18	457	25	23	25	38	54	15	737	1194	3.11
1	6	152	36	30	32	52	76	22	524	676	4.29
1	12	304	36	30	32	52	76	22	676	981	5.07
1	18	457	36	30	32	52	76	22	829	1286	6.62
1	24	609	36	30	32	54	76	22	983	1592	7.63
1.1/4	12	304	46	44	39	71	90	28	750	1055	9.60
1.1/4	18	457	46	44	39	71	90	28	912	1370	11.60
1.1/4	24	609	46	44	39	71	90	28	1055	1665	12.10
1.1/2	12	304	54	52		70	105	35	824	1129	13.31
1.1/2	18	457	54	52		70	105	35	975	1434	14.10
1.1/2	24	609	54	52		70	105	35	1129	1738	18.04
1.3/4	18	457	60	59		85	119	41	1076	1533	24.86
1.3/4	24	609	60	59		85	119	41	1229	1838	28.70
2	24	609	69	64		93	146	51	1401	2011	44.75
2.1/2	24	609	79	75		114	164	57	1488	2098	72.56
2.3/4	24	609	83	89		110	178	70	1562	2171	97.18

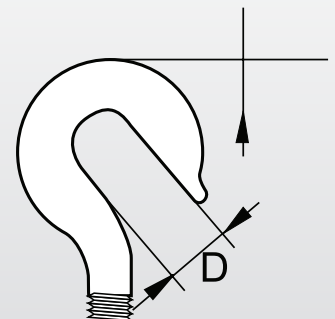
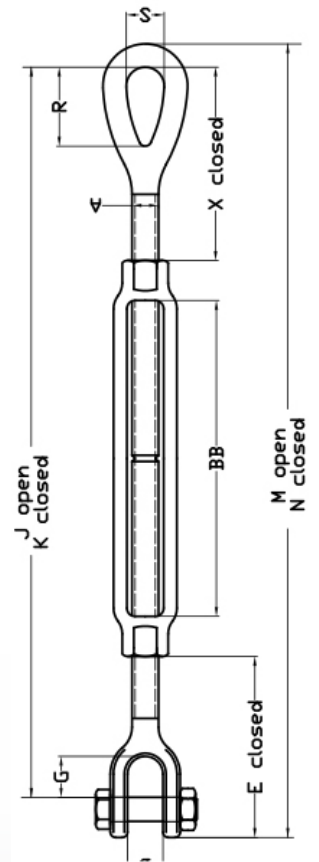

COLLARED EYEBOLTS

Metric Thread

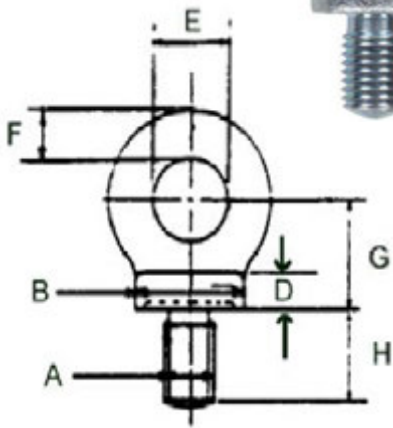

Sizes marked with * are additional & proportional to the specification

Also available in
B.S.W. U.N.C. & U.N.F.
Thread

Collared Eyebolts
BS EN ISO 3266:2010

	VERTICAL SWL TONNES	A mm	B mm	D mm	E mm	F mm	G mm	H mm	WEIGHT EACH KGS
*	0.10	6	22	7	15	9	20	18	0.06
*	0.15	8	22	7	15	9	20	18	0.06
*	0.25	10	22	7	15	9	20	18	0.06
	0.40	12	22	7	15	9	20	18	0.06
*	0.50	14	29	10	20	12	26	23	0.15
	0.80	16	29	10	20	12	26	23	0.15
*	1.00	18	36	12	24	14	32	28	0.27
	1.60	20	40	14	27	16	36	32	0.38
*	1.60	22	45	14	30	17	40	35	0.54
	2.50	24	52	17	35	21	46	40	0.85
*	2.50	27	58	20	39	23	52	46	1.13
	4.00	30	65	22	44	26	58	51	1.62
*	4.00	33	72	24	48	29	64	56	2.37
	6.30	36	81	27	54	32	72	63	3.12
*	6.30	39	86	29	57	33	76	67	3.81
	8.00	42	101	34	68	40	90	79	6.27
*	8.00	45	101	34	68	40	90	79	6.45
*	10.00	48	101	34	68	40	90	79	6.51
	12.50	52	115	38	76	46	102	89	9.58
	16.00	56	128	43	86	51	114	100	12.99
	20.00	64	144	48	96	58	128	112	18.20

Wire Rope Clips

Wire Rope Clips Generally to U.S. Fed. Spec. FF-C-450

- Material : SAE 1035 OR SAE 1045, high tensile steel.
- Finish : hot dipped galvanised

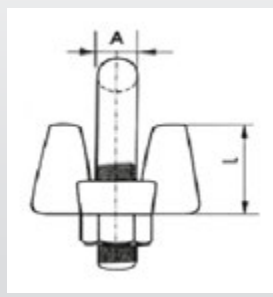
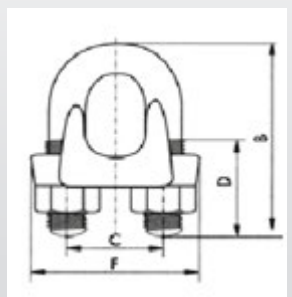

Wire rope dia	Bow dia	Overall length of bow	Inside width	Length of thread	Length of base	Thickness of base	Height of base	Approx. weight per 100 pcs
	D	d	a	C	C	2r	Screw pin	Safety pin
Inches	mm	mm	mm	mm	mm	mm	mm	kg
1/8	5	24	12	11	24	21	10	2
3/16	6	31	15	13	29	24	13	4
1/4	8	34	19	13	37	30	17	8
5/16	10	45	22	19	43	33	18	14
3/8	11	49	26	19	49	42	25	19
7/16	12	60	30	25	58	46	26	31
1/2	13	61	30	26	58	48	27	34
9/16	14	72	33	32	63	52	31	36
5/8	14	74	33	32	64	52	33	45
3/4	16	86	38	37	72	57	37	68
7/8	19	98	45	40	80	62	40	108
1	19	108	48	46	88	67	44	113
1 1/8	19	117	51	51	91	72	48	140
1 1/4	22	130	59	54	105	79	56	207
1 3/8	22	140	60	59	108	79	58	234
1 1/2	22	147	60	60	112	86	64	266
1 5/8	22	161	70	67	121	92	67	329
1 3/4	29	175	78	74	134	97	78	441
2	32	195	86	78	152	113	87	603
2 2/4	32	208	98	81	162	116	100	707
2 1/2	32	227	105	87	168	119	113	806
2 3/4	32	243	112	91	174	127	124	1000
3	38	271	121	104	194	135	136	1440

PLATE CLAMPS & PIPE HOOKS

Vertical Plate Clamps 500kg to 5 tonne



- Hardened steel jaws.
- Locking mechanism.
- Hinged attachment.
- Fully serviceable.
- Larger sizes available up to 12t

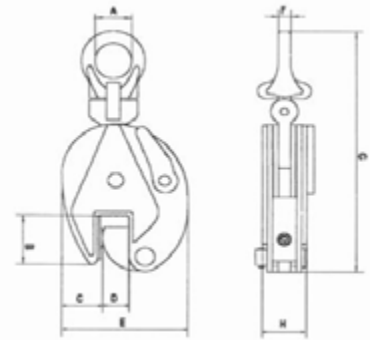

Product code	Capacity (Tonne)	A (mm)	B (mm)	C (mm)	D (mm)	E (mm)	F (mm)	G (mm)	G (mm)	Weight (kg)
VPC0.5T	0.50	30	43	35	0-15	105	10	218	45	2
VPC1T	1	48	63	51	0-20	145	12	305	63	5
VPC2T	2	68	76	59	0.25	175	16	368	68	7.5
VPC3T	3	74	85	56	0-30	218	20	395	90	15.5
VPC5T	5	80	90	65	0-52	240	222	450	88	22

Horizontal Plate Clamps



- Industrial Quality
- Quick & Easy Installation
- Locking Mechanism
- Larger Sizes available

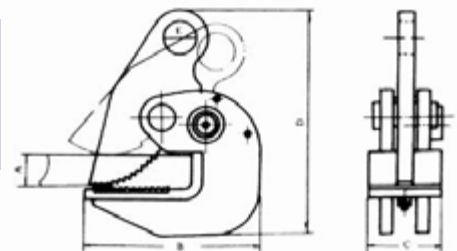

Product code	Capacity Each Pair		Jaw Opening (mm)	A max	B (mm)	C (mm)	D (mm)	E (mm)
HPC0.75T	750kg	1.5 tonne	0-25	25	125	50	175	25
HPC1.5T	1.5 tonne	3 tonne	0-30	30	157	65	204	30
HPC2.5T	2.5 tonne	5 tonne	0-45	45	231	90	310	40

Pipe Lifting Hooks



- Pipe lifting hook with surface Protection
- Easy to Operate
- Used In Pairs

Product code	W.L.L. Per Pair (in tonnes)	Max Pipe Wall Thickness (mm)
PIPE-HOOK-01786	3	40
PIPE-HOOK-01788	6	50
PIPE-HOOK-01789	8	70

WINCHES & ACCESSORIES

Snatch Blocks

- Greaseable load bearing.
- Greaseable swivel hook.
- Drop forged wheel.
- Shackle or Hook Fitting.



Item No.	Capacity (Tonne)	Sheave Size (inch/mm)	Wire rope Diameter (mm)
SBS/SBH-2	2	3/75	7 - 9
SBS/SBH-4	4	4.5/115	10 - 12
SBS/SBH-6	8	6/150	20 - 22
SBS/SBH-8	8	8/200	20 - 22
SBS/SBH-10	10	10/250	24 - 26
SBS/SBH-12	12	12/300	24 - 26
SBS-15	15	12/300	26 - 28
SBS-22	22	14/355	28 - 32
SBS-30	30	44/600	44

SBS - Snatch Block Shackle Type
 SBH - Snatch Block Hook Type

Industrial Hand Winch

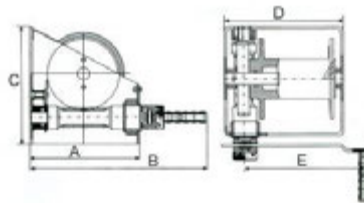

Product Code	WLL (kg)	Wire Rope Ø(mm)	Wire Rope Length(m)	No. Of layers	A (mm)	B (mm)	C (mm)	D (mm)	E (mm)	Speed
WINCH 250	250	5	20	4	150	330	150	200	240	1
WINCH-500	500	6.8	25	4	180	360	180	260	240	1
WINCH-1000	1000	9	35	4	300	490	300	300	370	1

Wire Rope Winches



- Easy & safe to operate.
- Very precise movement.
- Light to carry due to aluminium body.
- Coated finish.
- Easy replaceable overload pins (extra supplied).
- Easy to clean & service.
- Can be used for lifting, pulling & tensioning.
- Steel model available.

Product Code	WRW800	WRW1600	WRW3200	WRW5400
Lifting KG	800	1600	3200	5400
Pulling KG	1200	2500	5000	10800
Weight Inc 20 Mtr Rope	12KG	25KG	46KG	97kg
Rope Diameter	8.3 MM	11 MM	16MM	20MM

WALMAG PERMANENT LIFTING MAGNETS



WALMAG Permanent Lifting Magnets

Magnetic lifting made easy with WALMAG-series

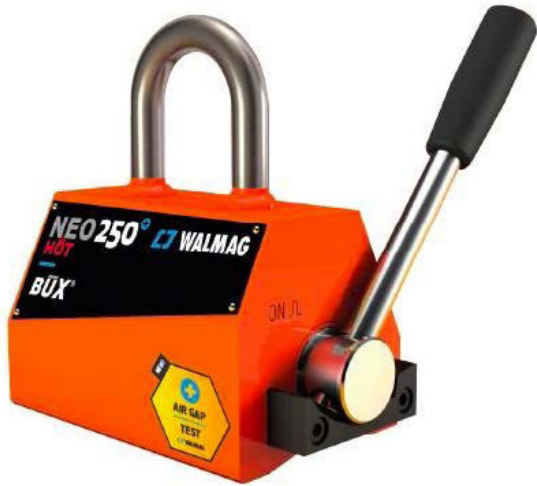

- State of the art two-pole design.
- Tremendous lifting capacity thanks to High-Energy Neodymium magnets.
- Increased airgap capability.
- Easy ON/OFF switching.
- Extremely compact, low dead weight.
- Robust, low maintenance.
- Smart design.

SPECIFICATIONS

Model	NEO 125	NEO 250	NEO 500	NEO 1000	NEO 2000
Nominal * Lift Capacity					
Flat Material [kg]	125	250	500	1000	2000
Round Material [kg]	50	125	250	500	1000
Tested** Break-Away Force [daN]	400	800	1600	3200	6000
Ø min./max. [mm]	50/100	60/200	65/270	100/300	150/350
Length [mm]	95	151	246	316	480
Width [mm]	60	100	120	148	165
Height [mm]	110	168	168	216	251
Mass [kg]	3	10	19	36	90

*Nominal lift capacity includes a safety factor of at least 3
Capacity varies with workpiece material, thickness and surface equality.

** Tested on a ground , 50mm thick , mild steel plate



WINCHES & ACCESSORIES

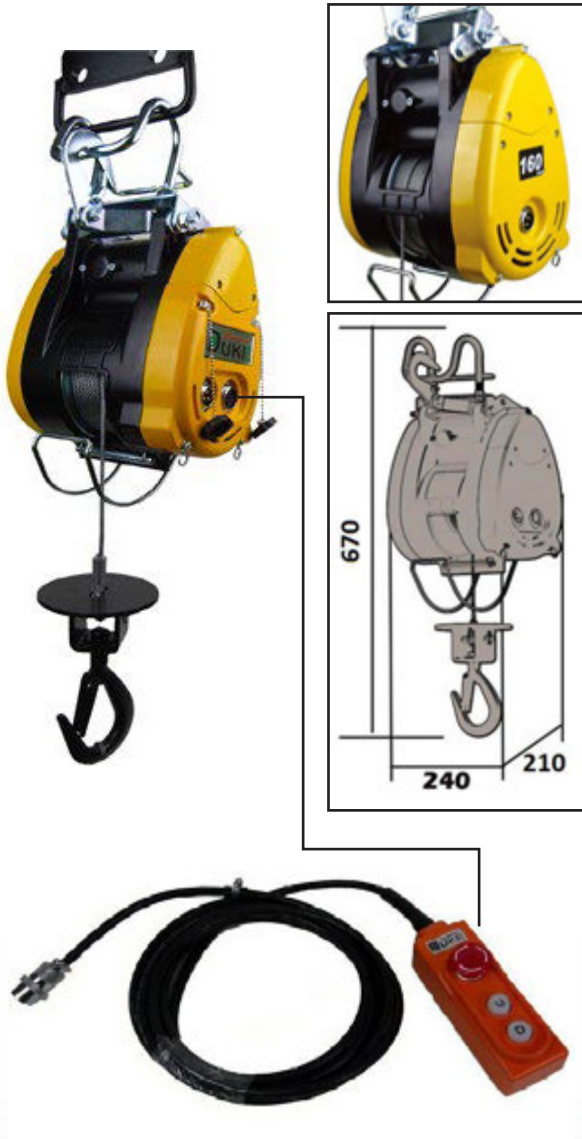

Electric Mini Wire Winch

Usage:

Fit For Various Construction Workplaces, Civil Engineering, General Factories, Plumbing, Coating Scaffolding, Warehousing, Buildings, Domestic, Farming And Fishing Industries, Stores and Even More.

Features:

Mini winch is compact and lightweight design allow mounting convenience. When rope touches the over-winding limit lever, hoisting is automatically stopped. An over reverse-winding limit lever stops the motor when the rope is reverse winging. Double safety brake devices, dynamic & electromagnet brake perform instant & safety brake. It operates on household power source. 360° universal joint saddle hook with safety latch. Plug-in cords allow portability with ease.

7M PUSH BUTTON SWITCH SET

MODEL:
DU-160A / DU-180A
DU-230A / DU-250A
DU-300A

Model	L (mm)	W (mm)	H (mm)	Package Box			Cu. Ft	N. W (Kgs)	G.W (Kgs)
				L (mm)	W (mm)	H (mm)			
DU - 75A	280	180	470	400	300	250	1'	8	15
DU - 160A	240	180	660	500	250	330	1.45'	15	23
DU - 160B	240	210	470	500	250	330	1.45'	15	23
DU - 180A	240	180	660	500	250	330	1.45'	15	23
DU - 230A	240	180	660	500	250	330	1.45'	16	24
DU - 250A	240	210	670	500	250	330	1.45'	20	28
DU - 300A	240	210	670	500	250	330	1.45'	20	28
DU - 260L	240	180	660	500	250	330	1.45'	15	26
DU - 330L	240	210	670	500	250	330	1.45'	20	31
DU - 160TH	240	180	660	500	250	330	1.45'	15	23
DU - 230TH	240	180	660	500	250	330	1.45'	15	23
DU - 250TH	240	210	670	500	250	330	1.45'	20	28
DU - 300TH	240	210	670	500	250	330	1.45'	20	28

WINCHES & ACCESSORIES

Electric Wire Winch



High Performance

Usage:

Fit for various construction workers, civil engineering, general factories, plumbing, coating, scaffolding, warehousing, buildings, domestics, farming and fishing industries, stores and even more.

Features:

Driving gear the heat treated gear with bearings features durable performance and anti-wear. Planetary and anti-wear gears. Compact and load sharing minimizes size, weight and cost. Full depth spur gear planetary reductions ensure quiet and long life. Gear box provides strength, durability and non-worry of breakage of structure. Ball bearings high efficient and heavy duty bearings provide long life. Brake designed for both static and dynamic loading. Brake will automatically apply in the event of power loss. Large friction surface area. No adjustments or serving requirement. Induction motor IEC induction motor mounted provides reality available, cost effective and service spares availability worldwide.

Model	Capacity (Kg)	Power (Voltage)			Phase		Wire Rope (mm)	Wire Rope Lift (Meter)	Speed (M/min)		Motor (HP)
		220	380	440	1	3			50Hz	60Hz	
DU - 201	150	220			1		5	25	15	18	0.5
DU - 202	200	220	220	380	1	3	6	30	15	18	0.5
DU - 204	250	220	220	380	1	3	6	30	15	18	0.8
DU - 221 H	250	220	220	380	1	3	7	30	38	40	1.5
DU - 205	300	220	220	380	1	3	7	30	15	18	1
DU - 208	350	220	220	380	1	3	7	30	15	18	1.5
DU - 223H	350	220	220	380	1	3	7	45	38	45	2
DU - 210	500	220	220	380	1	3	8	45	21	25	2
DU - 212	1000	220	380	440	3		10	45	12	15	3
DU - 2K	2000	220	380	440	3		12	45	12	15	5
DU - 213	2000	220	380	440	3		12	70	12	15	5
DU - 3K	3000	220	380	440	3		14	45	12	15	7.5
DU - 214	3000	220	380	440	3		14	70	12	15	7.5
DU -215	5000	220	380	440	3		16	70	12	15	10

WINCHES & ACCESSORIES

Electric Chain Hoist



PUSH BUTTON SWITCH SET



CHAIN BAG

ACCESSORIES



PUSH BUTTON SWITCH SET



CHAIN BAG



Model	Max (Kg)	Power (Voltage)			Phase	Trolley Speed (M /min)		Trolley Motor (HP)
		220	380	440		50Hz	60Hz	
DU - 102C	2000	220	380	440	3	18	22	0.5

Model	Capacity (Kg)	Power (Voltage)			Phase	Lift (Meter)	Chain (Falls)	Speed (M / min)		Motor (HP)	Load Chain (mm)
		220	380	440				50Hz	60Hz		
DU - 750	750	220	380	440	3	3	1	5	6	2	7.1
DU - 905	1000	220	380	440	3	3	1	5	6	2	7.1
DU - 906	2000	220	380	440	3	3	2	2.5	3	2	7.1

WINCHES & ACCESSORIES

■ Hoist Usage, Features, Specification

Usage:

It suitable for engineering hoisting, factory lifting operation, civil engineering water electrical wiring & piping installation, warehouse shipping purpose, etc. The application is very wide. It is also good for lifting, hoisting, pulling, etc. Operation suitably, to save labor. Save time, with high efficiency.

Features:

Motor System:

1. Applied with industrial grade high efficiency mice cage type induction motor.
2. With multi-output wires type, with 3 types of voltages options available.
3. Enameled wires with heat resistance up to 180 degrees Celsius, it is specially designed for long time hoisting purpose.

Brake System:

1. With unique designed brake systems for motor section and gear section.
2. Applied with high friction coefficient disk type brake lining, completely no adjustment required.
3. When it is power failure or broken is happened, promptly to start brake stop, safety is guaranteed. Operating life is more than 1 million times brake.

Electric Control System:

1. With 24V low voltage control, there is no electric shock worry during it is rainy, safe and stable.
2. Electric wiring cabinet with big current cartridge type PCB and Japanese type relay, with high quality, fast to change, operating life is more than 1 million times contact.

Safety System:

1. When chain is operating to upper limit and lower limit will be disconnected power automatically.
2. Inside with protect device for phase shortage, phase reverse, it will be stopped automatically when three phases power is short of phase and cannot use, to prevent motor burning from phase storage.
3. If three phases power is phase reverse, it will automatic to stop, cannot use, safety is guaranteed.

Chain Specification:

1. With genuine chain imported from Japan FEC company which is manufactured by this reputed manufacturer in this filed worldwide.
2. Made from alloy steel material with 80 grade and with 3 times safety coefficient.

Gear System:

1. With planetary speed reducing gear which is most efficiency.
2. The planetary gear unit is based on two steps types, the secondary step output gear unit is based on four piece of running idle wheel made by alloy steel with heat treatment for share force, the life is four times more longer than traditional transmission.
3. Gear box is made from FDC-45C casting iron material by one-piece formation, with high tenacity, by computer CNC machining, with high accuracy, low noise.

WINCHES & ACCESSORIES

Hoist Usage, Features, Specification

Main Body Frame:

1. With 5mm high strength steel plate to support frame of hoist.
2. The strength is three times higher than normal aluminium alloy beam.
3. Applied with electric coating is better to avoid rust, good for operation under badly environment when temperature is from MINUS 15 degree Celsius to 65 degree Celsius.

Housing Section:

1. Made from high strength steel plate and one-piece formed by big tonnage hydraulic power press. Absolutely without gap or joint.
2. Completely sealed with water resistance grade up to IP 65.
3. With automobile grade powder coating, appearance is beautiful.
4. With compact structure, effective to add upper, lower hoisting distance.

Upper Lower Hook Unit:

1. Made from alloy steel material by hot forging formation, with high strength, safety coefficient is four times.
2. Lower hook inside is applied with ball bearing to against 360 degree rotation. Danger will be happened during chain was twisted when it is hoisting heavy goods.

Control Switch:

1. With indirect type push button made in Taiwan, volume is small, easy to operate.
2. With water resistance grade up to IP 65, operating life is more than 1 million times.
3. Control wires is based on electric cable mixed with steel wires, it is durable for pulling and not easy to break.

SPECIFICATIONS

Model	L (mm)	W (mm)	H (mm)	Package Box			Cu. Ft	N. W (Kgs)	G.W (Kgs)
				L (mm)	W (mm)	H (mm)			
DU - 750	430	290	600	530	420	470	3.7	45	55
DU - 950	430	290	600	530	420	470	3.7	45	55
DU - 906	430	290	600	530	420	470	3.7	55	66
DU - 102C	470	295	241	570	400	340	3.7	39	40



Bottom Side Container Lifting Lugs



CFM Series Crane Forks



Top Container Lifting Lugs



SC92 Beam Clamp

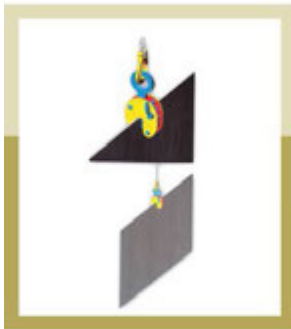

Universal Plate Clamp



Horizontal Plate Clamp



PH Pipe Hooks



Pulling Clamps



DCV 500 Drum Clamp



Pulling Clamp

CLOSED SPELTER SOCKETS

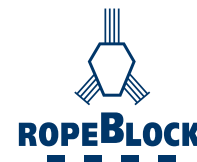

Quenched and tempered cast steel range with mechanical values (Charpy-V > 42 Joule / -20°C) for tough and low temperature use.

- For wire rope diameter 6 - 203 mm (1/4" - 8").
- All spelter sockets have a 100% efficiency.

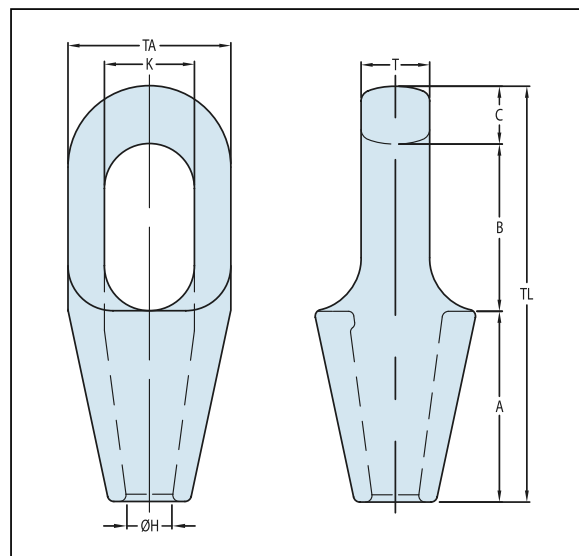

Model nr.	MBL (Mtons)	for wire Ø		Strand Ø		Dimensions (mm)								Weight (kg)
		mm	inch	mm	inch	A	B	C	ØH	K	T	TA	TL	
CSS 296	8	6-7	1/4	-	-	50	40	11	9,1	22	13	37	101	0,3
CSS 297	12	8-10	3/8	-	-	57	48	14	12,6	25	18	43	119	0,4
CSS 298	20	11-13	7/16 - 1/2	-	-	64	59	17,5	14,6	30	23	51	140	0,7
CSS 299	25	14-16	9/16 - 5/8	13	1/2	76	65	21	18,1	36	26	67	162	1,4
CSS 200	40	18-19	3/4	14-16	9/16 - 5/8	89	78	27	21,9	42	32	76	194	2,2
CSS 201	55	20-22	7/8	18-19	3/4	101	90	33	24,9	47	38	92	224	3,8
CSS 204	75	23-26	1	20-22	7/8	114	103	36	28,8	57	44	104	253	5,4
CSS 207	90	27-30	1 1/8	23-26	1	127	116	39	32,9	65	51	114	282	7
CSS 212	125	31-36	1 1/4 - 1 3/8	27-28	1 1/16 - 1 1/8	139	130	43	39,2	71	57	126	312	10
CSS 215	150	37-39	1 1/2	30-32	1 3/16 - 1 1/4	152	155	51	42,5	81	63	136	358	13
CSS 217	170	40-42	1 5/8	33-35	1 5/16 - 1 3/8	165	171	54	45,5	83	70	146	390	17
CSS 219	225	43-48	1 3/4 - 1 7/8	36-40	1 7/16 - 1 5/8	190	198	55	52,5	93	76	171	443	26
CSS 222	280	49-54	2 - 2 1/8	42-45	1 5/8 - 1 3/4	216	224	62	59,1	100	82	193	502	37
CSS 224	360	55-60	2 1/4 - 2 3/8	46-48	1 13/16 - 1 7/8	228	247	73	65,1	112	92	216	548	50
CSS 226	425	61-68	2 1/2 - 2 5/8	50-54	2 - 2 1/8	248	270	79	73,4	140	102	241	597	66
CSS 227	460	69-75	2 3/4 - 2 7/8	56-62	2 1/4 - 2 1/2	279	286	79	79,4	159	124	273	644	91
CSS 228	560	76-80	3 - 3 1/8	64-67	2 1/2 - 2 5/8	315	298	83	88,2	171	133	292	696	117
CSS 229	625	81-86	3 1/4 - 3 3/8	69-76	2 3/4 - 3	330	311	102	92,4	184	146	311	743	125
CSS 230	720	87-93	3 1/2 - 3 5/8	78-86	3 1/16 - 3 3/8	356	330	102	98,8	197	159	330	788	176
CSS 231	875	94-102	3 3/4 - 4	88-96	3 7/16 - 3 3/4	381	356	108	107,8	216	178	362	845	228
CSS 233	1200	108-115	4 1/4 - 4 1/2	98-110	3 7/8 - 4 5/16	450	425	125	129,5	235	190	405	1000	323
CSS 240	1400	120-130	4 3/4 - 5	112-124	4 7/16 - 4 7/8	500	525	125	147,1	260	200	450	1150	447
CSS 245	1600	135-140	5 1/4 - 5 1/2	125-132	4 15/16 - 5 3/16	540	495	150	153,9	290	220	520	1185	645
CSS 250	2000	142-153	5 3/4 - 6	133-143	5 1/4 - 5 5/8	585	530	170	171,1	305	240	545	1285	741
CSS 255	2220	154-165	6 1/4 - 6 1/2	144-154	5 11/16 - 6 1/4	630	565	175	185,1	330	250	575	1370	860
CSS 260	2500	166-178	6 3/4 - 7	155-166	6 1/4 - 6 3/4	680	590	180	199,1	330	270	595	1450	985
CSS 265	2800	180-191	7 1/4 - 7 1/2	167-179	6 9/16 - 7 1/16	725	620	190	213	350	290	625	1535	1183
CSS 270	3200	192-204	7 3/4 - 8	180-191	7 1/4 - 7 1/2	775	650	210	228,5	395	305	690	1635	1487

MBL = Minimum Breaking Load

The standard finish of our sockets is blue. Hot dipped galvanized is also available. Socket range CSS 296 until CSS 201 is delivered with galvanized finish, other finishes are available upon request. All sockets are provided with an EN 10204-2.1 declaration of conformity, EN 10204-3.1 material certificate and can be provided with a 2006/42/EC declaration where applicable.



OPEN SPELTER SOCKETS

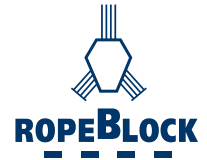

Quenched and tempered cast steel range with mechanical values (Charpy-V > 42 Joule /-20°C) for tough and low temperature use. For wire rope diameter 6 - 203 mm (1/4" - 8").

- Pin securing by cotter pin or bolt securing by nut and cotter pin.
- Optional is a flange connection for use with a bend stiffener.
- All spelter sockets have a 100% efficiency

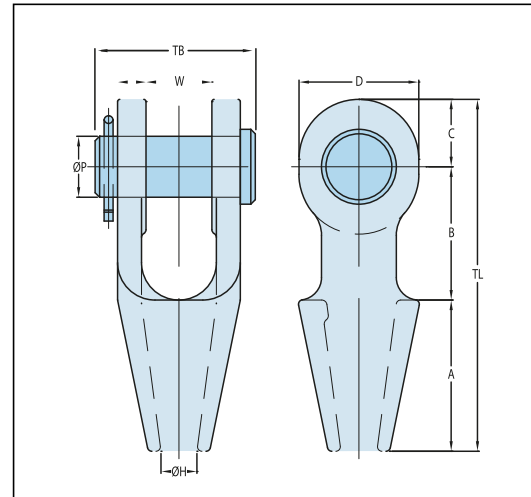

Model nr.	MBL (Mtons)	for wire Ø		Strand Ø		Dimensions (mm)										Weight (kg)
		mm	inch	mm	inch	A	B	C	D	ØH	ØP	T	TL	TB	W	
OSS 196 P	8	6-7	1/4	-	-	50	40	19	34	9	16	9	109	51	19	0,4
OSS 197 P	12	8-10	3/8	-	-	57	45	22	42	13	20	11	124	63	21	0,7
OSS 198 P	20	11-13	7/16 - 1/2	-	-	64	51	27	50	15	25	12	142	67	25	1
OSS 199 P	25	14-16	9/16 - 5/8	13	1/2	76	63	32	58	18	30	14	171	85	32	1,8
OSS 100 P	40	18-19	3/4	14-16	9/16 - 5/8	89	76	40	70	22	35	16	205	95	38	3
OSS 104 P	55	20-22	7/8	18-19	3/4	101	89	45	80	25	41	19	235	110	44	4,6
OSS 108 P	75	23-26	1	20-22	7/8	114	101	60	104	29	51	22	275	128	51	8
OSS 111 P	90	27-30	1 1/8	23-26	1	127	114	65	114	33	57	25	306	142	57	11
OSS 115 P	125	31-36	1 1/4 - 1 3/8	27-28	1 1/16 - 1 1/8	139	127	72	126	39	63	28	338	155	63	15
OSS 118 P	150	37-39	1 1/2	30-32	1 3/16 - 1 1/4	152	162	80	142	42	70	30	394	177	76	22
OSS 120 P	170	40-42	1 5/8	33-35	1 5/16 - 1 3/8	165	165	88	156	45	76	33	418	187	76	27
OSS 125 P	225	43-48	1 3/4 - 1 7/8	36-40	1 7/16 - 1 5/8	191	178	100	176	52	89	39	469	215	89	41
OSS 128 P	280	49-54	2 - 2 1/8	42-45	1 5/8 - 1 3/4	216	228	108	194	59	95	45	552	244	101	60
OSS 130 P	360	55-60	2 1/4 - 2 3/8	46-48	1 13/16 - 1 7/8	229	254	120	210	64	108	53	603	275	113	88
OSS 132 P	425	61-68	2 1/2 - 2 5/8	50-54	2 - 2 1/8	248	273	133	236	75	121	60	654	300	127	118
OSS 135 P	460	69-75	2 3/4 - 2 7/8	56-62	2 1/4 - 2 1/2	279	279	138	240	81	127	73	696	335	133	155
OSS 138 P	560	76-80	3 - 3 1/8	64-67	2 1/2 - 2 5/8	305	286	146	252	88	133	76	737	355	146	186
OSS 140 P	625	81-86	3 1/4 - 3 3/8	69-76	2 3/4 - 3	330	298	160	290	92	140	79	788	375	159	227
OSS 142 P	720	87-93	3 1/2 - 3 5/8	78-86	3 1/16 - 3 3/8	356	318	178	320	99	152	83	852	400	171	283
OSS 144 P	875	94-102	3 3/4 - 4	88-96	3 7/16 - 3 3/4	381	343	190	350	108	178	89	914	435	191	374
OSS 146 P	1200	108-115	4 1/4 - 4 1/2	98-110	3 7/8 - 4 5/16	450	480	215	400	129	195	100	1145	465	205	539
OSS 150 P	1400	120-130	4 3/4 - 5	112-124	4 7/16 - 4 7/8	500	500	250	450	147	220	110	1250	525	225	761
OSS 155 P	1600	135-140	5 1/4 - 5 1/2	125-132	4 15/16 - 5 3/16	540	497	263	480	157	240	140	1300	590	230	1067
OSS 160 P	2000	142-153	5 3/4 - 6	133-143	5 1/4 - 5 5/8	585	505	275	500	171	255	140	1365	610	250	1172
OSS 165 P	2220	154-165	6 1/4 - 6 1/2	144-154	5 11/16 - 6 1/4	630	530	300	550	185	275	150	1460	640	260	1441
OSS 170 P	2500	166-178	6 3/4 - 7	155-166	6 1/4 - 6 3/4	680	570	310	570	199	295	150	1560	660	280	1615
OSS 175 P	2800	180-191	7 1/4 - 7 1/2	167-179	6 9/16 - 7 1/16	725	600	325	600	213	310	155	1650	689	300	1907
OSS 180 P	3200	192-204	7 3/4 - 8	180-191	7 1/4 - 7 1/2	775	620	345	640	229	330	160	1740	720	320	2239

MBL = Minimum Breaking Load

The standard finish of our sockets is blue. Hot dipped galvanized is also available. Socket range OSS 196 until OSS 100 is delivered with galvanized finish, other finishes are available upon request. All sockets are provided with an EN 10204-2.1 declaration of conformity, EN 10204-3.1 material certificate and can be provided with a 2006/42/EC declaration where applicable.



OPEN WEDGE SOCKETS

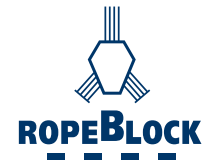

Fast detachable socket range for wire rope diameter 7 - 86 mm (5/16" - 3 3/8").
Basket and wedge in quenched and tempered cast steel. Wedge and basket are designed for easy installation and optimal wire rope efficiency.

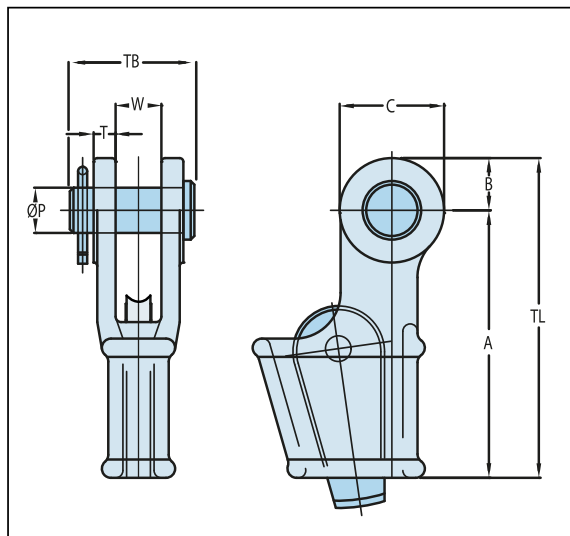

Model nr.	MBL (Mtons)	for wire Ø		Dimensions (mm)								Weight (kg)
		mm	inch	A	B	C	ØP	T	TL	TB	W	
OWS 0.25 P	8	7-8	5/16	110	18	36	16	9	128	51	18	0,8
OWS 0.5 P	12	9-10	3/8	145	23	46	20,6	11	168	63	20,5	1,7
OWS 1 P	20	11-13	1/2	146	28,5	57	25	12	174,5	67	25	2,1
OWS 2 P	25	14-16	5/8	176	35	70	30	15	211	85	31	4
OWS 3 P	40	18-19	3/4	210	40	80	35	16	250	95	38	7
OWS 4 P	55	20-22	7/8	237,5	47,5	95	41	18	285	110	44	10
OWS 5 P	75	24-26	1	275	55	110	51	22	330	128	51	15
OWS 6 P	90	27-29	1 1/8	310	65	130	57	25	375	142	57	21
OWS 7 P	110	30-32	1 1/4	350	73	146	63	28	423	155	63	31
OWS 8 P	125	34-36	1 3/8	400	74	148	64	28	474	160	70	37
OWS 9 P	150	37-39	1 1/2	450	80	142	70	30	530	177	77	51
OWS 10 P	170	40-42	1 5/8	500	87	160	76	33	587	187	76	64
OWS 11 P	225	43-48	1 3/4 - 1 7/8	550	100	186	89	39	650	215	89	96
OWS 12 P	280	49-52	2	640	105	205	95	46	745	244	101	130
OWS 13 P	360	54-58	2 1/4	660	125	250	108	54	785	275	114	180
OWS 14 P	425	60-68	2 1/2	835	135	270	121	60	970	300	127	275
OWS 15 P	460	72-76	3	1000	150	300	133	76	1150	355	146	440
OWS 16 P	625	81-86	3 1/4 - 3 3/8	1100	150	300	140	79	1250	375	159	510

MBL = Minimum Breaking Load

The standard finish of our sockets is blue. Hot dipped galvanized is also available. Socket range OWS 0.25 until OWS 0.5 is delivered with galvanized finish, other finishes are available upon request. All sockets are provided with an EN 10204-2.1 declaration of conformity, EN 10204-3.1 material certificate and can be provided with a 2006/42/EC declaration where applicable. Meets performance requirements of API 2C.



SKATES SETS

- Polyurethane wheels to prevent damage to flooring.
- Steering skates have 'easy spin' ball bearing turntables.
- Solid heavy duty Construction.
- Replaceable spare parts.
- Easy to Steer.



Product Code	Capacity in tonnes	Steering Skate Length (mm)	Steering Skate Width (mm)	Trailing Skate Length (mm)	Trailing Skate Width (mm)	Height (mm) All Skates
SKT8TS 4tonne steering 2 x2tonne trailing	8	240	210	170	130	110
SKT16TS 8tonne steering 2 x4tonne trailing	16	500	645	200	200	110
SKT24TS 12tonne steering 2 x6tonne trailing	24	530	750	200	220	110
SKT32TS 16tonne steering 2 x8tonne trailing	32	530	920	250	310	110
SKT36TS 18tonne steering 2 x9tonne trailing	36	610	750	310	240	110

HYDRAULIC EQUIPMENT

■ Toe Jacks



Capacity (tonne)	Lifting of foot (mm)	Lifting of head (mm)	Lowest of foot/head (mm)
5	230	575	25/368
10	260	650	30/420
25	275	720	58/500

MATERIALS HANDLING

Pallet Trucks

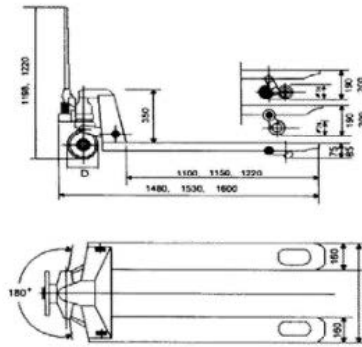

- Capacity of 2.5 tonne
- Available in two sizes: 550mm x 1100mm or 685mm x 1220mm
- Wheels & rollers manufactured in nylon
- Double rear rollers
- Tapered fork tips with guide entry rollers
- Replaceable spare parts
- Other models available

CAPACITY	FORK SIZE
2.5 Tonne	550mm X 1100mm
2.5 Tonne	685mm X 1200mm
3 Tonne	550mm X 1100mm
5 Tonne	550mm X 1100mm

High Lift Pallet Trucks



All types of Pallet Truck available
 Weighing. Stainless Steel.
 Gooseneck.
 Reel Carriers. Low Profile
 Pallet Trucks.
 Available to order

MODEL NO.	RATED CAPACITY KGS	FORK LENGTH	FORK WIDTH	MAX LIFTING HEIGHT MM	LOWERED HEIGHT MM
AHLPT-1	1000	1140	680	800	90

MATERIALS HANDLING

Material Lift



- We can supply all sizes of wind up lifts from 10 Feet to 25 feet.
- Compact design: Legs fold up or can be removed for storage.
- Easy to move into position.
- Various safe working loads available.
- Full spares back up.

Flat Bed Trolley



Hydraulic Hand Stacker



	1 KG = 2.2 LBS 1 INCH = 25.4 MM	
MODEL		SFH1016AG
Capacity	kg	1000
Lifting Height Max	mm	1600
Lifting Height Min	mm	70
Fork Length	mm	915
Fork Width	mm	100
Outer Width of Forks	mm	220 - 850
Base Legs I.D.	mm	915 - 1220
Base Legs O.D.	mm	1100 - 1370
Overall Length	mm	1420
Overall Width	mm	1100 - 1370
Overall Height	mm	2020
Load Center	mm	500
Rear Caster Dia.	mm	180
Front Wheel Dia.	mm	127
Rear Wheel Dia.	mm	180
Wheel Type		2 Rigid, 2 Swivel
Shipping Weight	kg	350

MATERIALS HANDLING

Barrel Tilting Fork Lift



- A spring load clamp securely holds any rimmed drum.
- Precision roller bearing load wheels for stability.
- Two rear swivel wheels for maneuverability.
- Moves poly, steel, or fiber drums on or off pallets with ease.

Specification	Unit	NBF35
Rated Capacity	Kg	350
Lifting Height	mm	1425
Overall Length	mm	1190
Overall Width	mm	890
Overall Height	mm	2020
Net Weight	Kg	155

Floor Crane SDJ



- Easy foldable design for compact storage when not in use.
- Six wheels giving extra stability (SDJ2)
- Two rear swivel wheels for maneuverability.



Specification	Unit	SDJ2	SDJ3
Lifting Capacity (boom extended - closed)	Kg	500 - 2000	1000 - 3000
Boom Length (closed - extended)	mm	960 - 1500	770 - 1400
Boom Height (closed - extended)	mm	350 - 1840	350 - 2200
Base Size	mm	1700 x 1010	790 - 2500
N.W. / G.W.	Kg	90/95	126 - 132
Package Dimension	mm	1510 x 300 x 170 820 x 580 x 90	1330 x 860 x 100 1470 x 300 x 200 700 x 180 x 150

FORK TRUCK ATTACHMENTS

Yoke with Hook



- Clamps firmly anywhere along forks.
- Negligible truck deration.
- Standard models from 1 to 5 tonnes.
- Large swivel hook with safety catch.
- Easy to attach.

- Easy to attach.
- Large swivel hook with safety catch.
- Models with the ability to extend the jib (Manually or Hydraulic).
- Other variants & models built to order please ask.

Fork Mounted Jib



Fork Extensions



- A simple but effective way of lengthening your forks to handle longer loads safely.
- Full range to suit forks up to 200mm wide.
- Fully certified for peace of mind.
- Toes profiled and chamfered for ease of use.
- Extensions held firmly in place with integral retaining bar.
- Heavy duty versions available for greater extension length.

- A fork-mounted range of attachments, designed to carefully balance and handle long and wide loads.
- Prevents sagging when loading or racking plastic pipes, extrusions, etc.
- Reduces damage to wide loads.
- Easy to attach and remove.
- Reduces load loss through imbalance.
- Fits securely onto fork truck.
- Available in four or six fork configuration.

Multi Fork Extensions

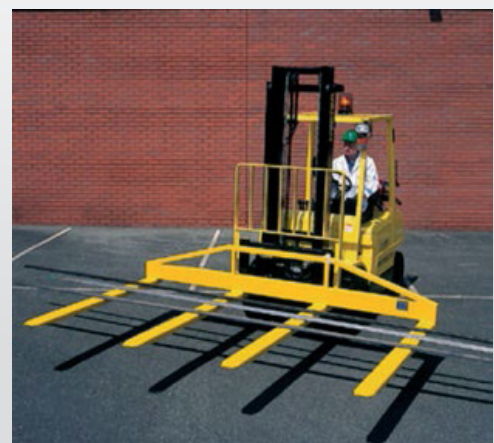

FORK TRUCK ATTACHMENTS

Drum Rotator



- Designed for the controlled and effortless pouring of contents from all types of drum.
- Eliminate manual handling.
- Allow pouring from any height.
- Models available for any drum type.
- Fitted & removed in seconds.
- Drums rotate through 360 degrees.
- Handle or chain options for operation.

Drum Rotator Crane & Forks

- Designed for the controlled and effortless pouring of contents from all types of drum.
- Eliminate manual handling.
- Allow pouring from any height.
- Models available for any drum type.
- Fitted & removed in seconds.
- Handle or chain options for operation.
- This model can be used on a forklift or crane.



Drum Tongs



- Designed to handle 210 litre drums, this simple grab is semi automatic in operation.
- May be used under an overhead crane or lorry mounted crane.
- May be used on a fork truck (see yoke and fork mounted jibs).
- Handles 210 litre steel or plastic drums.
- Ideal for lowering drums below ground level.

- Anti-trap hand rail and high backguard. 1 or 2 man models.
- Positive fixing to truck forks.
- Kick rail around base.
- Non-slip floor with drain holes.
- Integral safety harness rail.
- We also supply man baskets for use on cranes (see height safety section).
- Please ensure you are wearing adequate safety equipment.

Access Platform

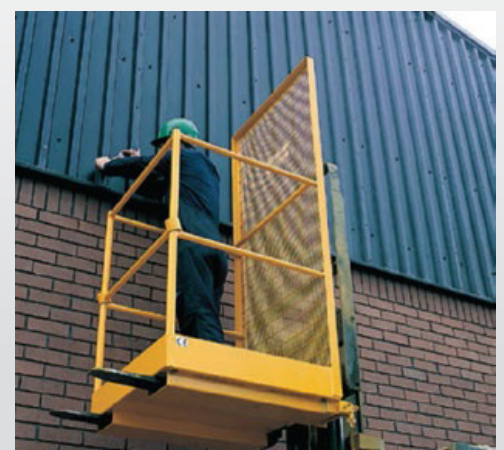

LASHING EQUIPMENT

Ratchet Lashing

- Available in any length.
- Readily Available in 6m, 8m & 10m



Rated Assembly Strength	500kg	5 tonne	10 tonne
Webbing Width	25mm	50mm	75mm
Hook Type	Claw	Claw	Claw
Colours available	Orange, Blue, Black, Red and Green	Orange, Blue, Black, Red and Green	Yellow

Ratchet Load binder

- Heavy duty ratchet load binder.
- Drop forged/cast steel, quenched & tempered.
- Fitted with chain grab hooks.
- Minimum breaking load 3.5 times the lashing capacity.

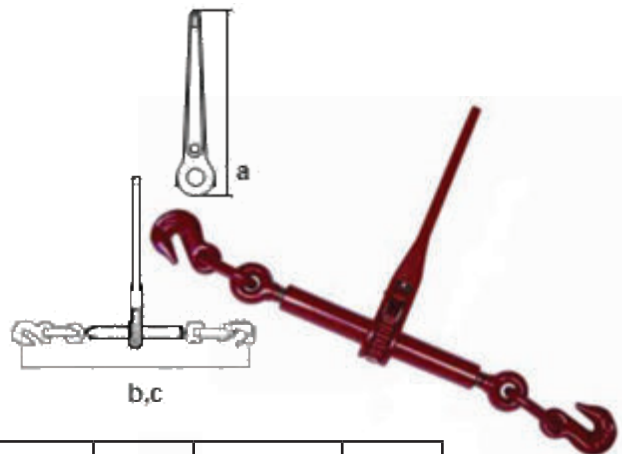

Product Code	Chain Size (mm)	Lashing Capacity (tonnes)	Proof Load (tonnes)	Minimum Breaking Load (tonnes)	Length A (mm)	Length Open B (mm)	Length Closed C (mm)	Adjustment (mm)	Weight (kg)
LBR8-10	8 - 10	2.45	4.9	8.62	355	750	580	170	4.82
LBR10-13	10 - 13	4.175	8.35	14.97	355	770	600	170	5.92
LBR13-16	13 - 16	5.9	11.8	20.865	355	840	685	155	7.85

Load binder Chain



10mm Grade 80 Chain	12,852 kgs minimum breaking strength
13mm Grade 80 Chain	21,624 kgs minimum breaking strength
16mm Grade 80 Chain	32,624 kgs minimum breaking strength

Grab Hooks



- Grab hooks are always available for chains.
- Please contact us for details.

HEIGHT SAFETY EQUIPMENT

Man Basket Standard: BS EN 14502-1:2010



HEIGHT SAFETY EQUIPMENT

P-10 Safety Harness

Ref. AB 110 01
EN 361

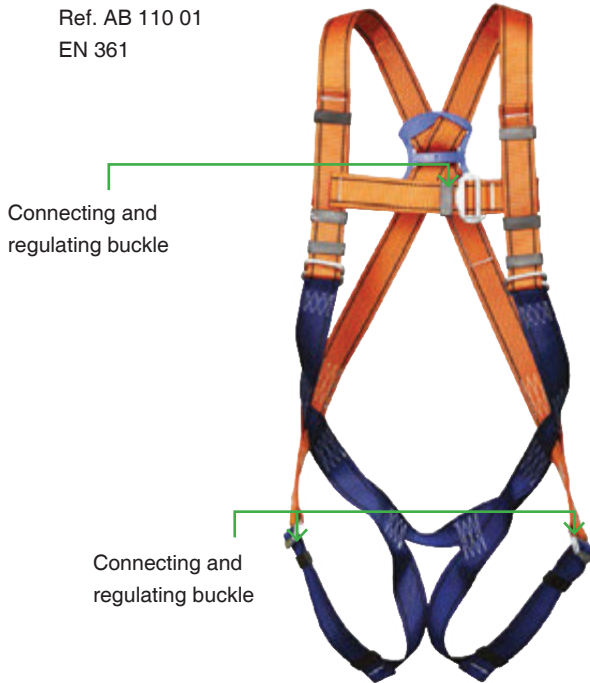

Size	Weight
M-XL	870g
XXL	900g

P-30 Safety Harness

Ref. AB 130 01
EN 361

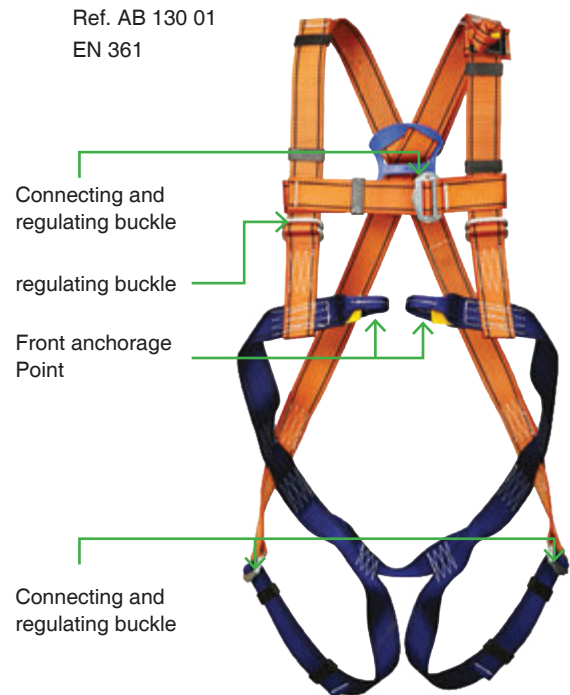

Harness with front and dorsal anchorage point.
Separate regulation for legs and shoulders straps.

Size	Weight
M-XL	1000g
XXL	1060g

Model P-10 Safety Harness



Model P-30 Safety Harness



Model P-50 Safety Harness



- Full safety harness.
- Comfortable to wear.
- Rear "D" attachment.
- Double adjustment (leg & chest).
- Easy to fit.
- Extremely light / comfortable
- Available in sizes M / XL / XXL
- Complies to BS EN 361:2002

- Full safety harness.
- Comfortable to wear.
- Front & Rear "D" attachment.
- Double adjustment (leg & chest).
- Easy to fit.
- Extremely light / comfortable
- Available in sizes M / XL / XXL
- Complies to BS EN 361:2002

- Full safety harness.
- Comfortable to wear.
- Front & Rear attachment.
- Front attachment for rescue
- Double adjustment (leg & chest).
- Easy to fit.
- Extremely light / comfortable
- Available in sizes M / XL / XXL
- Complies to BS EN 361:2002

HEIGHT SAFETY EQUIPMENT

Shock Absorbing Lanyards



- 2m length
- Quality Webbing
- Complete with shock absorber
- Complete with scaffold hook one end & alloy karabiner at the other
- Complies to BS EN 355:2002



- 2m length
- Quality Webbing
- Complete with shock absorber
- Complete with an alloy karabiner at both ends.
- Complies to BS EN 355:2002



- Y Lanyard
- Quality Webbing
- Complete with shock absorber
- Supplied with scaffold hooks
- Complies to current legislation

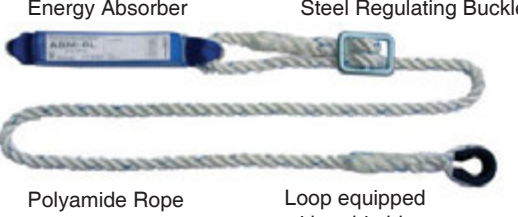

Energy Absorber Steel Regulating Buckle

Polyamide Rope Loop equipped with a thimble



ABM Ref: BW200
Energy Absorber



ABM-L Ref: BW300
Energy Absorber with lanyard



ABM-RL Ref: BW100
Energy Absorber with adjustable lanyard



ABM-T Ref: BW700
Energy Absorber with webbing



ABM-2L Ref: BW600
Energy Absorber with double lanyard



ABM-2RL Ref: BW500
Energy Absorber with double adjustable lanyard

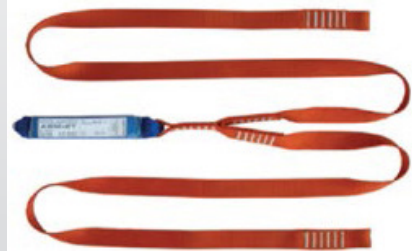

ABM-2T Ref: BW800
Energy Absorber with double webbing

HEIGHT SAFETY EQUIPMENT

Work Positioning Lanyards

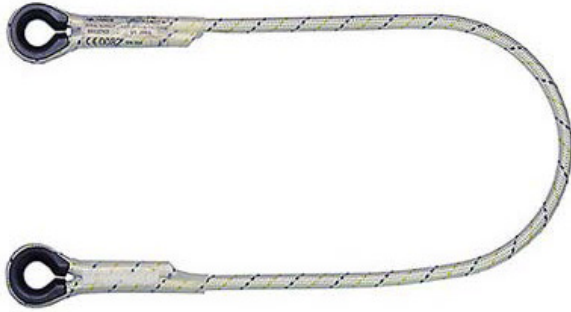

- Ref: AF310 05 – LENGTH 0.5m
- Ref: AF310 15 – LENGTH 1.0m
- Ref: AF310 15 – LENGTH 1.5m
- Ref: AF310 20 – LENGTH 2.0m

Work Positioning Device



- Ref: AF 100 20 – LENGTH 2m
- Ref: AF 100 30 – LENGTH 3m

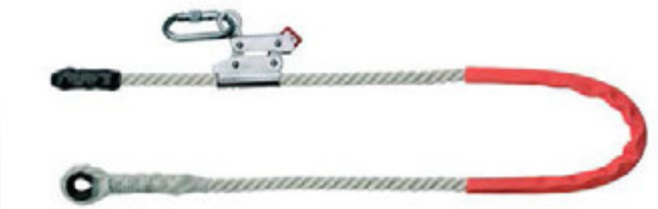

- Ref: AF 110 20 – LENGTH 2m
- Ref: AF 110 30 – LENGTH 3m

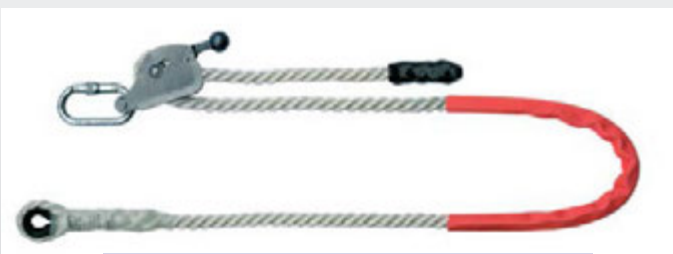

- Ref: AF 200 20 – LENGTH 2m
- Ref: AF 200 30 – LENGTH 3m

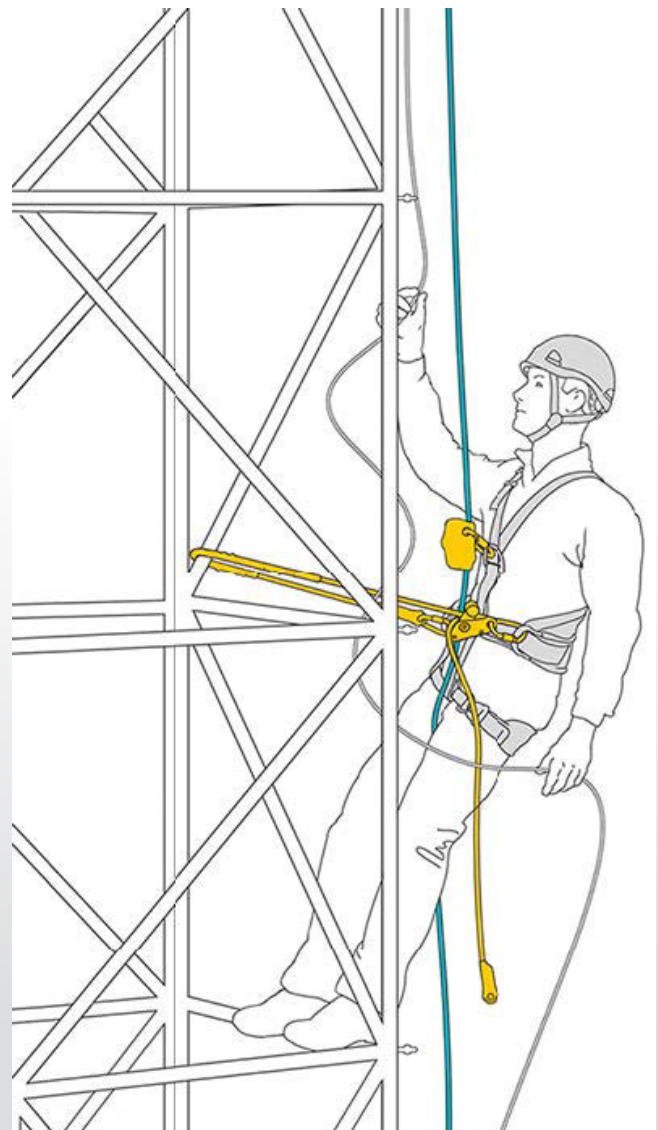

HEIGHT SAFETY EQUIPMENT

Universal Safety Lanyards



Ref: LB 111 05 – LENGTH 0.5m

Ref: LB 111 10 – LENGTH 1.0m

Ref: LB 111 15 – LENGTH 1.5m

Ref: LB 111 20 – LENGTH 2.0m

- **Can be used as:**
- Restraining lanyard
- Work positioning lanyard

Karabiners & Attachments

Karabiners comply with standard BS EN 362:1993



AZ200 3
Pipe Anchor



AZ023
Scaffold Hook
Opening 50, 60
& 100mm



AZ011
Karabiner steel
screw lock
Opening 17mm



AZ011T
Karabiner steel
twist lock
Opening 17mm



AZ013
Karabiner light
alloy screw lock
Opening 21mm



AZ012
Karabiner light
alloy screw lock
Opening 17mm

The snap hooks* that can be used on absorber's and lanyard's end



AZ 003

AZ 004

AZ 002

AXK 10

AZ 005

AZ 022

AZ 023

AZ 024

AZ 025

All snap hooks are CE Certified

▼ Light Alloy Construction

HEIGHT SAFETY EQUIPMENT

Tripod & Winch



- Aluminium construction for ease of lifting 2.14 meters fully extended, 1.34 meters fully retracted
- Telescopic legs
- Secondary safety anchorage
- Supplied with security chain around base
- Stabilizing feet with rubber grips
- Easy to erect
- Winch has 20 meters of galvanized cable
- Automatic brake
- Easy attachment of winch to tripod
- Both items comply to EN standards



Tripod complies with standard

BS EN 795 CLASS B: 1997

Winch complies with standard

BS EN 1496 CLASS B: 1996

P10 R Rescue Harness



- Easy to fit rescue harness
- Complete with front & rear fall arrest points
- Loop for attachment of rescue equipment
- Double adjustment for comfort
- Complies to current registration
- Size M – XL

Vertical Safety Lines



- Easy to use
- Strong & reliable
- Ropes lengths available to suit your needs

MODEL
AC 010 Vertical rope grab with shock absorber
AC 102 20 Meter rope, 14mm diameter
AC 102 30 Meter rope, 14mm diameter

HEIGHT SAFETY EQUIPMENT

■ TM 12 Spider Multi-Purpose Lifting Device



Use as a full set

- Lifting & lowering of a person and/or equipment up to 1 tonne.
- Designed for use in confined space areas.
- Lightweight & portable as the TM12 breaks down into 3 key components.
- Flexibility, functions as a gantry when used as a whole assembly, or just the tripod assembly can be used for confined space lifting or lowering of people or equipment.
- Fully adjustable in both length & height.
- Extra gripping thorns on tripod feet for improved traction on slippery surfaces.
- Safety locking pins to prevent movement of a Beam Trolley.



or as a tripod

HEIGHT SAFETY EQUIPMENT

■ Stretcher



- Aluminium or steel tubular bars fitted with canvas top
- Steel DX 017 Stretcher
- (Canvas) (211L x 50W x 12H cms)
- Aluminium DX 018 Stretcher (Canvas)
- (218L x 50W x 12H cms)
- Legs fitted with PVC stumps

Ref.
DX 017 – Steel
DX 018 -Aluminium

■ Rolex Mini Block



- 2.65 meter retraction
- Quality webbing
- Complete with shock absorber
- Unique energy absorbing protection on block casing
- Complete with upper & lower attachments
- Complies to BS EN 360:2002

■ Bosuns Chairs



RETRACTABLE TYPE FALL ARRESTERS

Retractable Type Fall Arrester CR200



- Retractable type fall arrester with galvanized 4mm wire rope
- Available in the following sizes: 6m, 12m & 15m
- Fully serviceable
- Lower swivel hook has fall indicator
- Lightweight
- AZ011 karabiner included
- Made in Europe

Retractable Type Fall Arrester CR300



- Retractable type fall arrester with galvanized 4mm wire rope
- Available in the following sizes: 20m, 25m & 28m
- Fully serviceable
- Lower swivel hook has fall indicator
- Lightweight
- AZ011 karabiner included
- Made in Europe

Retrieval Fall Arrest Block CRW300



- The CRW300 operates as a standard fall arrest block, but should the user fall they can be winched up or lowered to safety without delay.
- The fall arrest block has an integral winch which is simple to operate and will function as a normal fall arrest block when the winch is not engaged.
- The CRW300 has optional brackets allowing it to be fitted directly to the leg of a Rescue Tripod.
- Lightweight Aluminium Alloy casing
- Zinc Galvanized Steel Wire Rope
- Conforms to EN360, EN1496

MODULAR SPREADER BEAMS

SPREADER BEAMS • LIFTING BEAMS • LIFTING FRAMES

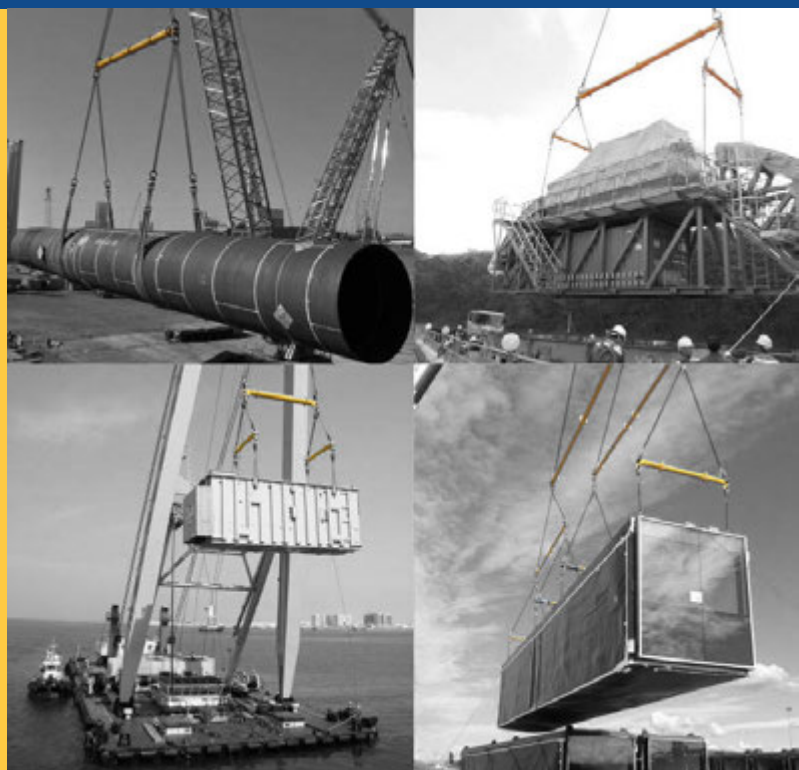

Modulift are the premium supplier of Spreader Beams for lifting, Lifting Beams, Spreader Frames and other below the hook heavy lifting equipment. As specialist lifting engineers operating in a niche market, we concentrate on the provision of off-the-shelf and Custom Lifting Products.

Modulift Modular Spreader Beams provide the ideal solution for most lifting requirements - versatile and cost-effective, the Spreader Beam range has capacity from 2 to 5000t with spans up to 100m/330'.

- Modulift Standard Spreader Beam Range up to 100t
- Modulift Heavy Spreader Beam Range up to 1000t
- Modulift Super Heavy Spreader Beam Range up to 5000t

Lifting Equipment Specialist

- Off-the-shelf spreader beams available for quick delivery
- 2 - 5000 tonne capacities & spans up to 100m
- **DNV DESIGN APPROVED**
- Custom designed engineering services available to meet the most stringent quality assurance standard.
- Experts in manufacturing products suitable for use in extreme conditions.
- Proof load test and / or third party witness tests available on request.



All Modulift products are designed and manufactured in the UK

The Modular Spreader Beam configuration and interchangeable components enable Modulift Spreader beams to be reused over many lifts. Designed by engineering experts and manufactured in own specialist facilities; the Modulift range are the leading Modular Spreader Beams on the market. Every Modulift Modular Spreader Beam consists of a pair of End Units and a pair of Drop Links, with interchangeable struts that can be bolted into the assembly between the End Units to either lengthen or shorten the beam to suit the requirements of the lifting, making them reusable at different spans.

MODULIFT SPREADERS OUTPERFORM THE COMPETITION!

Quality Engineering	Modulift is a team of a specialist engineers designing innovative products to optimum specification to ensure a safe lifting environment around the world.
Interchangeable	The modular struts allow for multiple lengths to be configured for a variety of lifts, Mix and match end units with beams when long length, yet weight is required.
Economical	One Modulift Spreader System can be used over and over again for years.
Portable	Our heaviest and longest strut is only 6m- small enough for the back of a truck! Many of our Spreader Systems can be handled by one person. Our Quick Joint2 comes in a handy carrying case complete with shackles!
Lightweight	Our Spreader Systems are specially designed to provide you with a lightweight solution so your cranes can work at maximum capacity without the weight of heavy lifting gear.
Easy to store	For improved inventory control, organized components, quick retrieval and mobilisation, ask about our storage systems.
Adaptability	Drop links provide 6" of rotation for give and take to allow for lower sling misalignment.



HIGH PERFORMANCE STEEL WIRE ROPES

Verope AG is a Joint Venture company between Pierre Verreet, head and founder of verope, and KISWIRE Ltd. from South Korea. The concept of verope is to provide affordable high quality special wire ropes for crane applications to the world market.

■ EXCELLENT QUALITY

Verope is meeting customers' demands for quality and safety by offering special wire ropes that are made out of compacted strands, fully lubricated and layered with plastic between the steel core and the outer strands. These ropes have much higher breaking loads and are more flexible compared to conventional wire ropes. In addition they withstand dynamic forces, provide maximum performance and operate smoothly. The high breaking loads of verope special wire ropes give a competitive edge to our customers by allowing reducing the diameters of the sheave and drumming and the size of motor and gearbox. Furthermore, they allow longer service life due to lower specific stress on the rope. Most importantly, they provide increased reliability by means of excellent quality and safety. Our special wire ropes are a product you can rely on. We will focus on developing high value-added products - the next generation of special wire ropes.

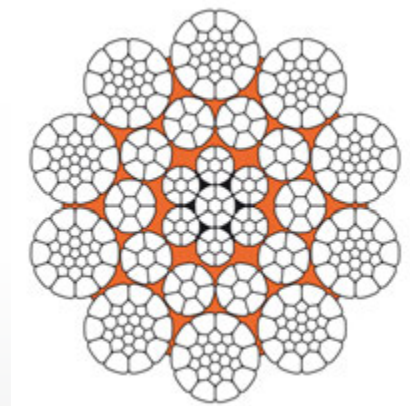

■ HIGH PERFORMANCE

The excellent quality of material, the special design and the structural stability of verope special wire ropes increase performance most effectively and lead up to long term high performance. Longer service life, superior durability, safety and efficiency are the distinguishing features that make special wire ropes stand out clearly from the regular wire rope. Usually, these differences in quality between standard- and special wire ropes translate into significant price advantages. Verope and KISWIRE maintain cutting-edge competitiveness in all fields of business, pricing policy included. Lean structure, continuing management innovations, excellent product development, streamlined research analysis, cost reduction, improved productivity and strict quality control. It is efficiency that leads to our convincing price-performance ratio.

HIGH PERFORMANCE STEEL WIRE ROPES

Introduction

The concept of Verope AG is to provide affordable high quality special wire ropes for crane applications to the world market. The new catalogue contains a well selected range of products, which have been approved by leading crane manufacturers. The products are available at our distributors in 25 countries in different continents.

We at Verope AG are pleased and proud to have satisfied our clients' needs worldwide and will continue in our uncompromising mission of high service standards, combined with quality products that you can rely on. Your requirement is our focus.

Advantages of Verope

- Excellent strength to weight ratio
- Long fatigue life
- Good abrasion and wear resistance
- Good non-rotation properties
- Easy rope handling
- Excellent corrosion resistance
- Reliable quality assurance



Rotation-resistant rope, suitable as hoist rope for mobile cranes, tower cranes, crawler cranes, piledriving equipments.



Rotation resistant rope, suitable as hoist rope especially for cranes working in marine environment such as desk cranes, offshore cranes.



8-strand non rotation resistant rope suitable as hoist ropes for multiple part reeving systems with right – and left hand layed ropes working as a pair such as container cranes, steel mill cranes, overhead travelling cranes.



8-strand non rotation resistant hoist rope with compacted outer strands for container handling cranes, steel mill cranes, mobile harbor cranes, overhead travelling cranes, boom hoist application.



6-strand non rotation resistant rope with compacted and rotary swaged strands. Suitable as hoist rope for cranes with guided loads working in multiple layer on the drum, such as boom hoist ropes for mobile cranes, crawler cranes, grap applications etc. can also be used as hoist rope for container handling cranes, overhead travelling cranes.



8-strand non rotation resistant rope with compacted and rotary swaged strands. Suitable as hoist rope for container cranes, steel mill cranes, boom hoist applications, etc. Very high breaking strength and most suitable for multi-layer spooling devices.

HIGH PERFORMANCE STEEL WIRE ROPES

Introduction

Originally founded in Taiwan in 1987, Britx Wire Rope Ind. Corp. is a well-known wire rope manufacturer focusing on high quality products in various fields including industrial ropes, control cables for automobile industry, elevator ropes, etc.

Currently more than 60% of products are for the overseas market. The company is built up with significant experience in rope production and management system by integrating both Taiwan and China's excellences.

"Perfect Quality" is a BRITX's goal in which we have provided the best quality with achievements in quality management systems including

ISO 9001:2008, JIS G 3525:2006
ISO/IEC17025:2005, ISO/
TS16949:2002

BRITX will continue to work hard and sincerely with its excellent quality and service to fulfill the commitment to our global customers for years to come.

The different wire rope constructions we offer are

- Steel Wire Rope Rotating 6 x 19
- Steel Wire Rope Rotating 6 x 36
- Steel Wire Rope Non Rotating 19 x 7
- Steel Wire Rope Fibre Core 6 x 24
- Stainless Steel Wire Rope 7 x 19
- PVC Coated Wire Rope 7 x 19

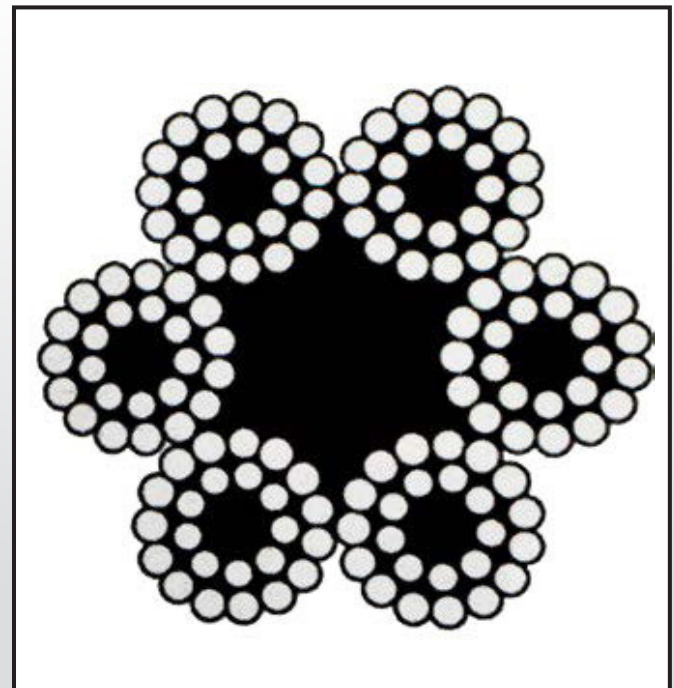
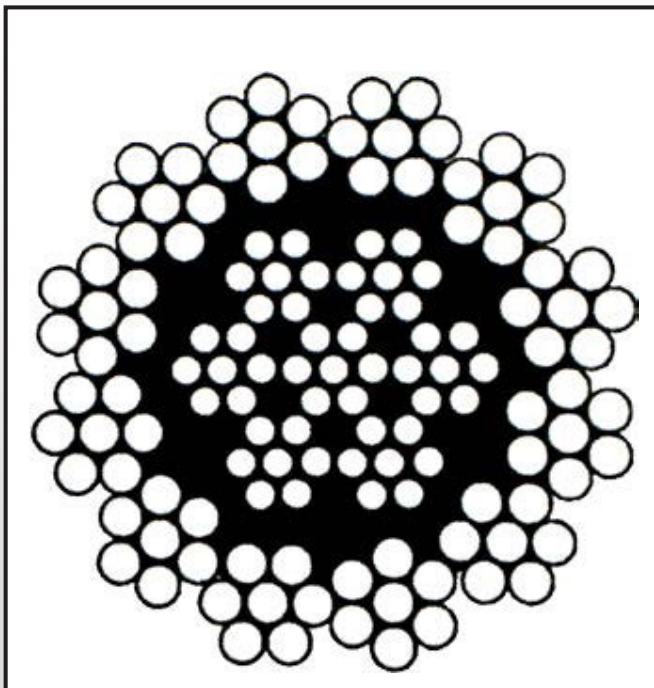
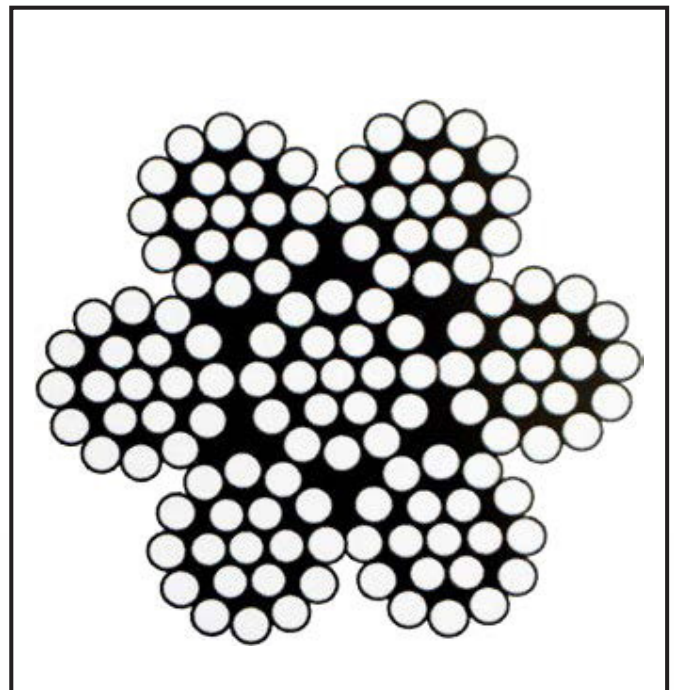

MONITORING EQUIPMENT

Introduction

Since 1976, Straightpoint have been the world leaders in the design and manufacture of a huge range of force measurement, load cell dynamometers for load monitoring and crane scales for suspended weighing load cells up to 1000t / 2.2 million lbs. capacity.

Straightpoint is the international standard for lifting projects; supplying load link load cells, dynamometers, load shackles, provided cabled or wireless (telemetry), crane scales, center of gravity and data logging systems.

In an industry where safety and quality are paramount, Straightpoint designs and manufactures to the highest standards, builds measurement equipment with world-class technical expertise and can deliver solutions quickly from its many locations around the world.

Straightpoint products offer load monitoring, weighing and force measurement solutions, and can be found in oil and gas, shipping, construction, renewable energies, lifting and cranes, mining, staging, test and inspection, and military applications.

The Products Include:

- Loadlink Plus
- Radiolink Plus
- Compound Plus
- Wireless Shackle Loadcells
- Wireless Centre of Gravity System
- Wireless Accessories
- Wirelink Plus
- Shackle Loadcells
- Load Pins
- Mineweigher Plus
- Jumboweigher
- 'S' Beam Loadcells
- Loadblock Plus
- Compression Loadcells



STEELWORK CLAMPING SYSTEM

Introduction

For more than 80 years, Lindapter has earned a respected reputation as the inventor and pioneer of steelwork clamping systems, providing an independently approved and exclusive product range of

- Steelwork Fixings
- Cavity Fixings
- Decking Fixings
- Support Fixings
- Floor Fixings
- Rail Fixings



Whether joining primary structural sections, securing secondary beams or suspending building services, Lindapter has a proven, accredited solution.

Lindapter has manufactured to the highest standard for three quarters of a century, earning a multitude of independent approvals and a reputation synonymous with safety and reliability. Current accreditations awarded by international associations include Lloyds Register, TÜV NORD, Deutsches Institut für Bautechnik and Det Norske Veritas.



Lindapter is specified on countless projects across the globe from the Antarctic to the Caribbean, in diverse applications as varied as the London Tower Bridge, Target Field Ballpark, Dubai Shopping Mall and Gautrain Rapid Rail Link.



Lindapter is a member of the following organisations:



CA LIFTON HYDRAULIC POWER SYSTEMS

■ Introduction

CA Lifton Hydraulic power systems Inc. is a team of dedicated professionals with wide experience and expertise in high pressure hydraulic tools. The company geared its operation in early 2000 and with short span of time Litton proved its presence through distinct and reliable product range. The company proved to be one of the best through technology, innovation and continuous product development. Extremely wide range of products are accepted in different industry sectors like oil & gas construction, maintenance, marine & shipyards, mining, railways, steel & cement industries, heavy fabrication & erection, power plant, petrochemical industries, pipeline installations, EPC & MEP contractors. Lifton with Head office in Canada, operates from regional offices and distributor network to reach maximum number of customers globally

■ Hydraulic Pipe Bender



- Capacity: 2", 3" & 4"
- Maximum pressure: 700 bar
- Stroke 225 – 300 mm
- Cylinder: 10 – 20 tonnes



- Hydraulic Cylinders
- Pumps
- Bolt Tensioners & Tensioning Pumps
- Crimpers, Cutters & Punches
- Hydraulic Torque Wrenches, Pumps, Hoses. Accessories & Sockets
- Hydro Test Pumps
- Toe Jack, Punch Head and Nut Splitters
- Torque Wrenches & Impact Wrenches





■ ATG GLOVES

Focused on innovation and quality, ATG® designs, develops and manufactures gloves that enhance the performance of the most sophisticated work tool, the hand. We believe in keeping it simple and offer just 4 brands that are skin friendly, extremely comfortable and highly durable.

All our gloves are dermatologically accredited by the Skin Health Alliance and are post washed prior to packaging enabling us to guarantee them “fresh out of the pack” as certified by Oeko-Tex®. All ingredients used in the production of our gloves are according to REACH and none of our product contains SVHC.

In an industry driven by outsourcing, ATG® is a traditional manufacturer that uses the very latest technologies to deliver class leading gloves. We do everything ourselves and guarantee that nothing is outsourced.



■ WHAT MAKES ATG GLOVES DIFFERENT?

ATG®'s technology platforms are continuously developed by a core team that matches market research and marketing analysis with the latest technological developments. This forms the foundation upon which we continually improve the customer's experience through constant innovation. Why? It is because we understand the complexity of choosing and implementing a hand protection program that works and is adopted by all. On one side, your workforce continually asks for gloves that are more comfortable whilst on the other side there is a focus to reduce injuries, the costs associated with those injuries and to improve worker efficiency.

We aim, via use of our technology platforms, to combine comfort and worker acceptance with performance and safety features. We have also recently added a “well being” technology platform that takes care of your hands during and after work.

Our products include technologies that follow one of three themes:

1. Comfort
2. Performance
3. HandCare™

These technologies are used individually or collectively to provide you with the glove that is guaranteed skin friendly thanks to our partnership with the Skin Health Alliance. All our gloves are designed to last and can be laundered to ensure that we are able to maintain our commitment to you of “value for money”.





■ Lifting & Rigging

Jtagz® products are the perfect solution for all of your lifting and rigging Inspection and Identification needs.

Lifting equipment is subject to strict industry regulations for the safety of everybody. To ensure all of your lifting and rigging gear remains compliant, it is necessary that a competent person perform periodic inspections certifying that your gear is in accordance with any applicable safety regulations. These regulations can vary worldwide so please review your state/country standards.

Our RigTag® products have been designed specifically for the Lifting and Rigging Industry and will withstand the harshest of environments! Easily tag your gear with tamper evident vibrant coloured tags, custom branding and unique alphanumeric serial numbers!

■ Working at Heights

Equipment used for height safety and fall protection is subject to strict industry regulations for your safety and the safety of those around you. To ensure all of your harnesses, lanyards and other fall arrest equipment remains compliant, it is necessary that a competent person performs periodic inspections certifying that your gear is in accordance with the manufactures specifications, and any applicable safety regulations and standards. Here at Jtagz® we have a range of high quality products that are perfect for identifying your inspection periods. This ensures that your gear remains compliant and inspection schedules are met every time. All of our products come in a range of vibrant colours and can be custom printed with your inspection and identification information.

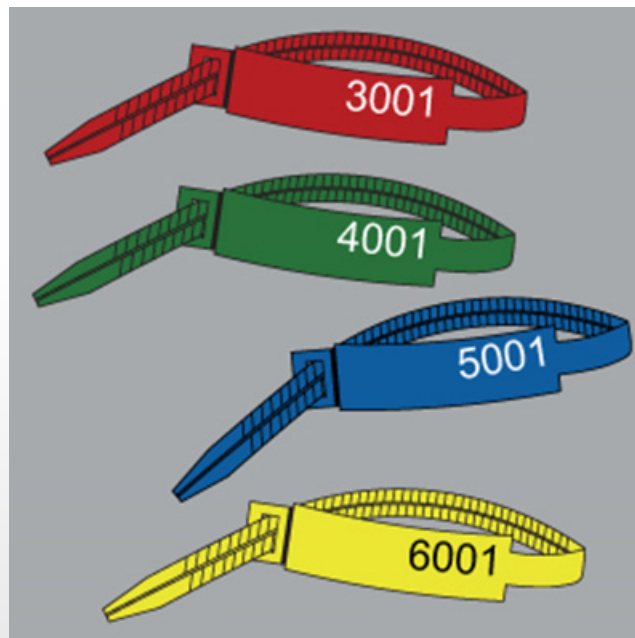

■ Inspections and Servicing

All inspections and repairs/services should be carried out by a qualified inspector, and details of the current status of all equipment inspected should be provided. All equipment that has been inspected should be colour coded with an approved colour inspection tag for a designated period of time. Items those are no longer safe/fit for use should be tagged so and removed from service.

■ Hydraulics & Pneumatics

Jtagz® products are the perfect solution for all of your Hydraulics and Pneumatics Identification needs. Our products are an effective means of quick visual identification, they are simple to apply and are resistant to oil, grease, abrasions and hydraulic fluids.

■ Electrical Test & Tag

Electrical Equipment and appliances require frequent visual inspections and electrical testing by a competent person to ensure that they are safe for use. Regulations and terminology can vary worldwide so please review your current state/country standards.

Jtagz® has a range of Test Tag products that are perfect for identifying that an inspection has taken place.



■ Providing Visual ID Tag Solutions for over 35 years.

The RigTag® is our most sought after product and is suitable for all working environments. Our RigTags have a variety of purposes; however they are most commonly used to identify periodic inspections on lifting and rigging equipment. Jtagz® RigTags will endure the harshest conditions and last the distance every time. Available in two sizes 175mm & 300mm



- Available in 14 colours for 175mm
- Available in 12 colours for 300mm
- Hot Foil Custom Printing
- Strong Dual Clasp
- Non-Reusable / Tamper Evident
- Made from Durable Nylon 66
- UV Stabilised
- Waterproof
- Australian Made

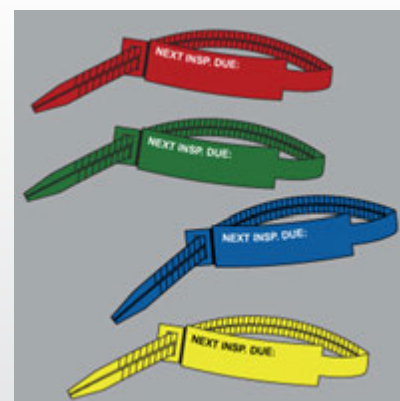

Gigasense heavy duty product program for

CRANE SAFETY AND FORCE MEASUREMENT

■ Shaft Load Cell (SLC)



For overload protection and/or load indication in a conveyor, crane or other device. Easily replaces the existing shaft at an equalizing pulley or in other parts of the construction. Customized design.

■ Electronic "clamp-on" Force Transmitter (LKVE)



Can be used in systems for overload protection and load indication on single and multiple hoists. The signal can be connected to a PLC Programmable Logic Controller or to any PIAB Electronic Unit.

■ Mechanical "clamp-on" force transmitter (LKV/X)



Intended for use as an overload guard, load guard, force control switch, crane guard, load limiter or as a slack rope switch in lifting equipment.

■ Overload Guard Electronic Unit



Mainly used together with one load cell/force transmitter in order to protect a lifting device against overload.

■ Gigasense Anti Collision System



A fail-safe anti-collision system/collision avoidance system for track bound cranes (EOT) or similar equipment in tough industrial environment.

SAFETY RADIO REMOTE CONTROLS FOR HAZARDOUS AREAS

Our vision is to create radio remote control solutions that enable our customers to achieve accident free operation in hazardous area environments. We are guided by principals of honesty, integrity and a steadfast belief that customer safety and satisfaction is our number one job! Hetronic is committed to innovative Human-Machine Interface (HMI) technology that will fully satisfy our customers' needs for safe, reliable and affordable hazardous area radio remote controls. Our products include standard systems for off-the-shelf applications or custom configured systems that are created to meet the customer specific application needs. In every case, our systems are designed to allow the operator to be safer, more efficient and productive while providing customers a strong Return-on-Investment (ROI)



Since our founding in 1983 Hetronic has become the industry leader in safety radio remote controls with over 400,000 systems delivered to a broad range of customers. Continuous improvement of our products, lean manufacturing processes, automotive level quality management systems in combination with global technical sales and voice of the customer (VOC) research activities are the basis for providing outstanding value to our customers and shareholders alike.

Hetronic is committed to meeting and possibly exceeding the expectations of its customers. Hetronic facilities that manufacture EX products are ATEX, IECEx and NCC certified, each having regularly maintained QAN and QAR documents

■ NOVA-XL SERIES RADIO REMOTE CONTROLS



Field proven in harsh environments, offers a larger control panel up to 4 joysticks and other controls. Capable of feedback via LED's or viewable LCD.

■ NOVA-L SERIES RADIO REMOTE CONTROLS



■ GL-2 SERIES REMOTE CONTROLS



Field proven in harsh environments, offers a larger control panel up to 4 joysticks and other controls. Capable of feedback via LED's or viewable LCD.

Compact, Rugged and ergonomically designed for ultimate operator performance. Configurable with up to 2 joysticks for specific applications.

■ GL-3 SERIES RADIO REMOTE CONTROLS

Designed with enough space for feedback via LED's and LCD display. Heavy duty, field proven GL-3 can be optionally equipped with cable control.



■ GR SERIES RADIO REMOTE CONTROLS



A workhorse transmitter for any environment, the GR offers extra space for a variety of control elements. Available with feedback on LCD display or LED's and optional cable control. Ergonomically designed for operator comfort and control with chest plate or waist belt.

■ ERGO-F HANDHELD RADIO REMOTE CONTROLS



The ERGO-F transmitter is a one-hand controller designed to meet the most rugged of applications. ERGO-F comes standard with a highly readable display for machine feedback and immediate button response. Hetric key switch with RFID technology offers a wide range of options for operator safety.

■ RECEIVERS – ENCLOSURES



**EXd
Enclosures**



**GRP
Enclosure**

GIS – CH ELECTRIC CHAIN HOIST: SIMPLE, RELIABLE, SECURE.

- Complete range of market services for off-floor goods handling
- A wealth of know-how – from planning through to installation
- We manufacture quality products – «Made in Switzerland»
- Our approach is based on reliability and service

- COMPACT DESIGN
- ROBUST CONSTRUCTION
- EASE OF MAINTENANCE
- AVAILABILITY ASSURED
- ADVANCED TECHNOLOGY
- SWISS QUALITY
- LIFTING CAPACITY UP TO 5000 KG
- PROTECTION CLASS IP 55 (OPTION IP 65)



■ WORLD'S FIRST IN SAFETY

- Double slip clutch (best overload protection ever). Authority's safety test passed superbly! Five times more secure than the regulations require!
- Highest safety with brake positioned after the slip clutch
- End of chain is fixed to the hoist body
- Standard geared limit switch: chain length up to 220m
- Made for industrial use: body and covers completely built in aluminum
- Jamming of the chain excluded due to two part plastic chain guide and external chain guide plate

■ WORLD'S FIRST IN SERVICE AND HANDLING

- Easy adjustment of the slipping clutch
- No special tools or electronic devices required
- Maintenance free brake system
- Chain guide removable without disassembly of the hoist
- Easy conversion from 1 to 2 fall (double load capacity)
- Ergonomic 2 and 4 button control pendant with support wire
- Silent working due to helical gears
- Standard low voltage control (42 V)



AN OVERVIEW OF GIS



■ LIFTING TECHNOLOGY

GIS electric chain hoists (up to 5000 kg)

- Low wear, reliable, easy to maintain
- Application: stationary, movable on I-beams or combined with GIS crane system



■ CRANE TECHNOLOGY

GISKB crane system (up to 2000 kg)

- Modular concept
- Single and double bridge suspended crane for all-round goods transportation
- Monorail with bends and switches for linebound transportation
- Lightweight design



GIS travelling cranes (up to 5000 kg)

- Designed to customer specifications
- Conventional design
- Especially suitable for larger spans

GIS slewing pillar and wall cranes (up to 1000 kg)

- For use when ceilings have insufficient load-bearing capacity
- An ideal addition to your suspended crane
- Quick to plan, simple, easy to handle



■ VACUUM LIFTING TECHNOLOGY

Gentle lifting with GIS vacuum equipment (up to 500 kg)

- For all types of surfaces and a huge variety of products
- Can be combined with electric chain hoists/wire rope hoists



ENERGY AND DATA TRANSFER SYSTEMS FOR MOBILE CONSUMERS

We energize mobility. Worldwide.

As one of the leading manufacturers of motorised cable reels, spring cable reels, and slip ring bodies, Hartmann & König Stromzuführungs AG supplies its customers worldwide with technologically advanced energy and data transfer systems for mobile consumers. The high-quality „Made in Germany“ cable reels are used on container, deck and construction cranes, excavators or hoisting equipment of all types – and wherever mobile consumers require a reliable supply of power, data or other media.

Our expertise is reflected in an impressive product portfolio of state-of-the-art cable reels and slip ring bodies. Innovative capability, reliability as well as the flexibility of a medium-sized company contributed to the success of Hartmann & König.

Our expertise in the area of energy delivery to mobile consumers is based on more than 70 years experience in the development as well as production of cable reels and slip ring systems. We support our customers with a dedicated team of engineers and designers, who develop solutions for the most challenging applications. In this way, we can offer virtually all types of motorised cable reels tailored to customer requirements for spiral or cylindrical winding and unwinding of cables, ropes or hoses.



■ SPRING CABLE REELS

Spring cable reels supply cranes, loading plants and forklift trucks with reliable mobile energy and they are used in stage technology, in sewage plants and in many other applications. Depending on the intended purpose and installation requirements, these consist of a cylindrical or spiral-winding reel body, the spiral leaf spring drive made of premium-grade, texture-milled spring band steel, and a slip ring body or a rotary feedthrough for hose reels.

- Maximum speed 60 m/min
- Various sizes and model series for supplying short distances – distances of up to 60 m are also possible
- Cylindrical or spiral-winding reel bodies
- For energy and data cables as well as hoses for liquid or gaseous media
- Available from stock: Standard cable reels ready to ship in 48 hours



SLIP RING BODIES



Slip ring bodies are used wherever energy, data, control signals or other media must be transferred from a rotating to a stationary part. They are designed in combination with cable reels and as stand-alone systems. By using a modular design for open or encapsulated slip ring systems (with or without bearing), we can produce the majority of slip ring bodies on demand – cost-effectively and quickly. Just one of the many factors guaranteeing the longevity of our products is the high protection class for electrical components. This ensures that they are ideally suited to harsh environmental conditions.

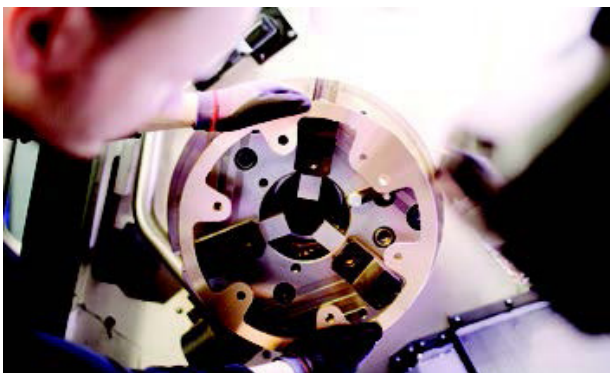

- Transfer energy, data and control signals from a rotating to a stationary technical component or vice versa
- Used in combination with cable reels or as stand-alone modules
- Areas of application: in rotating construction machines, slewing jibs, drilling machines, waste incineration plants, stage technology etc.
- Open or encapsulated slip ring bodies with or without a bearing
- Encapsulated version with protection class IP55 or higher

MOTORISED CABLE REELS



Motorised cable reels by Hartmann & König are the ideal solutions when it comes to providing reliable energy supplies to all types of cranes, excavators and numerous other types of hoisting equipment. For every installation set-up and supply requirement, we configure the optimum cable reel with suitable drives and accessories in order to meet the demands of mobile consumers. Our highly resilient reel bodies made of galvanised and deep-drawn sheet metal are available in welded and screw-mounted versions. If required, we can offer a variety of surface treatments to withstand even the toughest climatic or chemical influences.

- Ideally suited for high speeds, dynamic processes, long distances and high tensile forces
- Travel ranges up to 1000 m+
- Configuration of motorised cable reels and drives according to the respective customer wishes
- Spiral or cylindrical winding and unwinding of cables and hoses
- Compatible with virtually all motorised drives



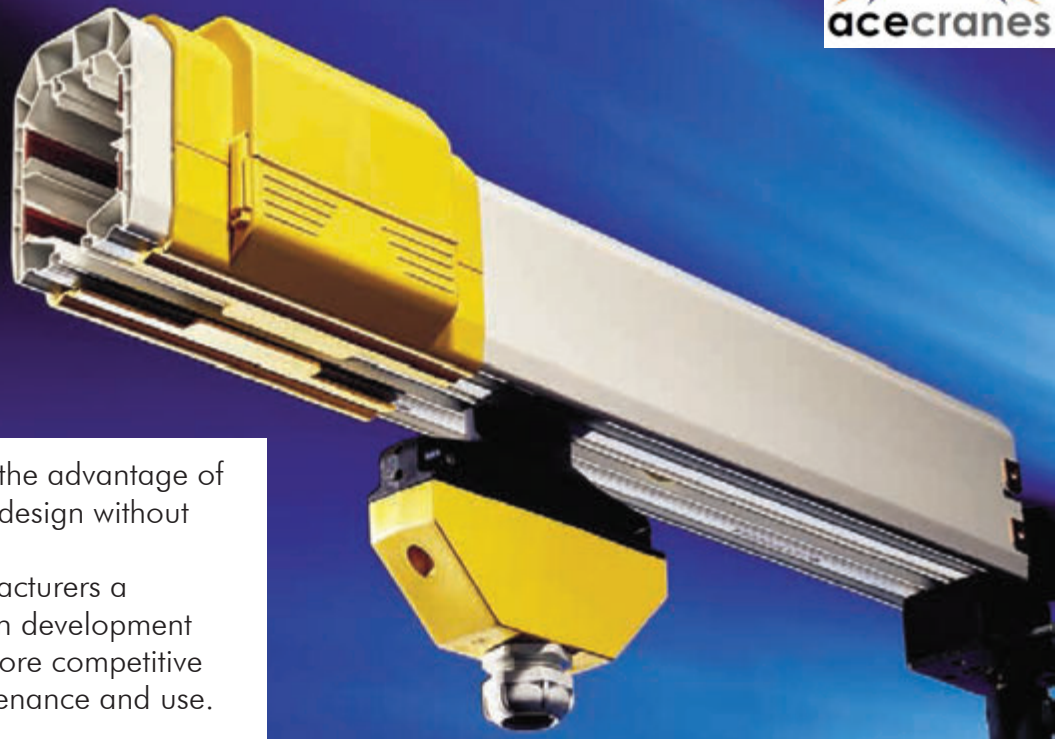

MOBILIS Elite has the advantage of high performance design without additional costs. Thus giving manufacturers a competitive edge in development and marketing : more competitive assembling, maintenance and use.

Thanks to its limited number of parts, the systematic use of easily removed connections, and rapidly fitted accessories (without tools), MOBILIS Elite offers installers a system which is simple and quick to set up, whatever the location.

As well as complying with standards and regulations in force, MOBILIS Elite stands out for its hard-wearing qualities and ease of maintenance, thanks to the use of toolfree fitting of accessories.

A patented principle of self-breaking screws allows controlled fixings with complete security and reliability. In addition, an improvement makes a later removal easier.

- ◆ During fitting of line elements, the selfbreaking screw ensures optimum tightening torque for each fixing : once torque is achieved, the screw breaks.
- ◆ When the screw breaks, a second hexagonal end appears. This makes subsequent removal easier, using a simple key.

MOBILIS Elite makes the user's choice simpler by offering a complete

range of accessories, all ensuring protection of the line against rain (IP23), thanks to an integrated watertight system.

For easier fitting and maintenance, the main accessories have been designed for simpler, quicker, tool-free installation. The feeding box and covering flange are clipped on manually. However, they cannot be removed without the use of a tool, in accordance with regulations.

■ OUTSTANDING ADVANTAGES.

- Performance :
 - extensive range (20 to 200A)
 - light, rigid PVC profile
 - long lines without expansion joint
 - permanent modularity...
- Security :
 - protection index IP23 according to EN60529
 - self-extinguishing materials
- Fast assembling :
 - pre-assembled product (connection screws, protection lips...)
 - clip-on accessories (tool-free installation)
 - connections through self breaking screws
- Easy maintenance
 - carbons removable
 - easy removal of connections
- Modern design



الرفع لخدمات السلامة Lifting Safety Services LLC

■ Lifting ■ Jacking ■ Materials Handling ■ Height Safety

P.O. BOX 411, POSTAL CODE: 322
FALAJ AL QABAIL-SOJAR,
SULTANATE OF OMAN

+968 26755881
+968 26755882
INFO@LSSOMAN.COM
WWW.LSSOMAN.COM

IWRC CONSTRUCTION - 1960 GRADE - CLASS 6X 19, CLASS 6 X 36

Rope Diameter mm	Single Leg		Leg Angle 0 - 45°		Leg Angle 0 - 45°		Leg Angle 0 - 45°		Minimum Break Load Tonne	Proof Load Per Leg at 0 Degrees Tonne
	Tonne	2 Leg	2 Leg	3&4 Leg	2 Leg	3&4 Leg	3&4 Leg			
8	0.82	1.10	1.10	1.70	0.82	1.2	4.1	1.64		
9	1.0	1.4	2.1	2.1	1.0	1.5	5.2	2.0		
10	1.3	1.8	2.7	3.1	1.3	1.9	6.42	2.6		
11	1.5	2.1	3.1	3.8	1.5	2.2	7.77	3.0		
12	1.8	2.5	3.8	4.4	1.8	2.7	9.25	3.6		
13	2.1	2.9	4.4	5.2	2.1	3.1	10.8	4.2		
14	2.5	3.5	5.2	6.9	2.5	3.7	12.6	5.0		
16	3.3	4.6	6.9	8.6	3.3	4.9	16.4	6.6		
18	4.1	5.7	8.6	9.6	4.1	6.1	23.0	8.2		
19	4.6	6.4	9.6	10.7	4.6	6.9	23.1	9.2		
20	5.1	7.1	10.7	13.0	5.1	7.6	28.4	10.2		
22	6.2	8.7	13.0	15.5	6.2	9.3	31.1	12.4		
24	7.4	10.3	15.5	18.0	7.4	11.1	41.0	14.8		
26	8.6	12.0	18.0	21.0	8.6	12.9	43.4	17.2		
28	10.0	14.0	21.0	27.5	10.0	15.0	55.8	20.0		
32	13.1	18.3	27.5	33.0	13.1	19.7	72.9	26.2		
35	15.7	22.0	33.0	34.9	15.7	23.6	87.2	31.4		
36	16.6	23.2	34.9	38.9	16.6	24.9	92.2	33.2		
38	18.5	25.9	38.9	43.0	18.5	27.8	103	37.0		
40	20.5	28.7	43.0	52.1	20.5	30.8	114	41.0		
44	24.8	34.7	52.1	62.0	24.8	37.2	138	19.6		
48	29.5	41.3	62.0	72.9	29.5	44.3	164	59.0		
52	34.7	48.6	72.9	78.1	34.7	52.1	193	69.4		
54	37.2	52.1	78.1	84.2	37.2	55.8	207	74.4		
56	40.1	56.1	84.2	96.6	40.1	60.2	223	80.2		
60	46.0	64.4	96.6	114	46.0	69.0	256	92.0		
64	54.2	75.9	114	136	54.2	81.3	301	108.2		
71	64.8	90.7	136	161	64.8	97.2	360	129.6		
77	76.5	107	161	115	76.5	115	425	153		

This Table conforms to BS EN 13414-1 : 2003/A2 2008 except rated for a higher grade rope.

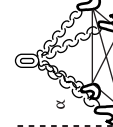
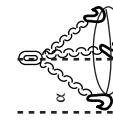

α Angle	90°	0-45°	45-60°	0-45°	45-60°	0-45°	45-60°	α Angle
Factor	1	1.4	1	2.1	1.5	2.1	1.5	
7 mm	1.5	2.1	1.5	3.15	2.24	3.15	2.24	
8 mm	2	2.8	2	4.2	3	4.20	3.00	
10 mm	3.15	4.4	3.15	6.7	4.7	6.70	4.70	Working Load Limit in Tonnes
13 mm	5.3	7.5	5.3	11.2	8	11.20	8.00	
16 mm	8	11.2	8	17.00	11.8	17.00	11.80	
20 mm	12.5	17.5	12.5	26.50	19	26.50	19.00	
22 mm	15	21.2	15	31.5	22.4	31.50	22.40	
26 mm	21.2	30	21.2	45	31.5	45.00	31.50	
32 mm	31.5	44.10	31.5	66.8	47.5	67.00	47.50	

This table conforms to BS EN 818 - 1 & 4

100% POLYESTER WOVEN WEBBING LIFTING SLINGS

Width mm	Colour	eye and eye type double layer		
		Straight lift WLL (kg)	Choked lift WLL (kg)	Basket lift WLL (kg)
25	Violet	1,000	8,00	2,000
50	Green	2,000	1,600	4,000
75	Yellow	3,000	2,400	6,000
100	Grey	4,000	3,200	8,000
125	Red	5,000	4,000	10,000
150	Brown	6,000	4,800	12,000
200	Blue	8,000	6,400	26.2
250	Orange	10,000	8,000	20,000
300	Orange	12,000	9,600	24,000

This table conforms to BS EN 1492 - 1 : 2000



الرفع لخدمات السلامة ش م م
Lifting Safety Services LLC

MUSCAT | DUQM | SOHAR



📍 P.O. Box 411, Postal Code: 322, Falaj Al Qabail-Sohar, Sultanate of Oman

☎ +968 26755881 📠 +968 26755882 ✉ info@lssoman.com 🌐 www.lssoman.com